

ASBESTOS REGISTER

053801 : NEWTOWN PRIMARY SCHOOL

NEWTOWN
EXETER
DEVON
EX1 2ES



NPS Property Consultants

Printed on 03/10/2023

Contents

1. Asbestos Register History

2. Executive Summary

3. Introduction

4. Asbestos register

5. List of Areas not Accessed

6. Layout Drawings

Attachments e.g. Bulk Analysis Certificates

1. Asbestos Register History of Surveys, Inspections and Notified Changes

This table lists all the visit records held against this site

Visit date	Surveyor	Visit type	Comments
11-Oct-2022	Chris Plant	Condition check of known asbestos items	Annual site check - No deterioration to the condition of ACMs noted during the inspection
5-Jul-2022	AMP team	Observation	Floor plans updated
13-Oct-2021	Jamie Wilson	Condition check of known asbestos items	Annual site check - No deterioration to the condition of ACMs noted during the inspection
23-Jun-2021	Allium Environmental Ltd	Refurbishment Survey	All areas affected by the proposed refurbishment works to the rooves of Block 02 as identified in the client provided scope of works and plan only within Newtown Primary School were included in the survey.
14-Oct-2020	Sally Herbert	ASB3 Form Return	Block 03 - ACM window putty removed - Windows removed throughout. Replaced with UPVC
14-Oct-2020	Chris Plant	Condition check of known asbestos items	Block 51 - ACM roof removed. Replaced with slate roof
26-Jun-2020	CASA Environmental Ltd	Refurbishment Survey	Annual site check - No deterioration to the condition of ACMs noted during the inspection
30-Oct-2019	Jamie Wilson	Condition check of known asbestos items	Refurbishment survey to areas of room GD0003DP and part of room GD0011CD affected by the proposed parquet flooring replacement works.
3-Sep-2019	AMP team	Observation	Annual site check - 633125 roof noted as replaced
14-Jan-2019	Allium Environmental Ltd	Refurbishment Survey	Floor plans updated
21-Nov-2018	Jamie Wilson	Condition check of known asbestos items	The client specified areas as identified on the client provided plans of Block 02 (works include the removal and replacement of the existing cast iron and UPVC rainwater goods to the pitched roofs of Block 02 including localised fascia replacement and decoration of the existing pitched roof dormers, replacement of the existing poly-carbonate roof sheet to the mono pitch canopy to facilitate gutter replacement) only within Newtown Primary School were included in the survey.

30-Jul-2018	HBI Ltd	Refurbishment Survey	<p>GF Entrance Hall (GD.0021): The ceiling and walls around proposed pipe run and inside boxing.</p> <p>GF School Reception Office (GD.0022): The ceiling and walls around proposed pipe run and new radiator and the existing gas fired water and surrounds.</p> <p>GF Small Staff Room (GD.0025): The ceiling and walls around proposed pipe run and new radiator and the existing gas fired heater.</p> <p>GF Group Room (GD.0017): The ceiling and walls around proposed pipe run and new radiator and surrounds.</p> <p>GF Large Staff Room (GD.0016): The ceiling and walls around proposed pipe run and new radiator and the existing gas fired heater and surrounds.</p> <p>GF Olive Class Room (GD.0018): The ceiling and walls around proposed pipe run and new radiator and the existing gas fired heater and surrounds. The area around the covered fire place.</p> <p>GF Boys Toilet (GD.0015), Girls Toilet (GD.0014) and Staff Toilet (GD.0013): The walls around proposed pipe run and new heaters.</p> <p>GF Music Class Room (GD.0012): The ceiling and walls around proposed pipe run</p> <p>Quiet (Thrive) Room (GD.0007): The ceiling and walls around proposed pipe run and new radiator and the existing night storage heater and surrounds.</p> <p>GF Hall (GD.0003): The walls around proposed pipe run and new radiator and the existing gas fired heater and surrounds. The area around the covered fire place.</p> <p>GF Kitchen (GD.0004): The floor, ceiling and walls around proposed pipe run and new radiator and the existing gas fired heater and surrounds. The area around the existing foritic water heater and proposed new location for the boiler.</p> <p>GF Gas Meter Room (GD.0002) in Block 51.</p>
6-Dec-2017	Jamie Wilson	Condition check of known asbestos items	Annual site check - No deterioration to the condition of ACMs noted during the inspection
29-Nov-2017	AMP team	Observation	Floor plans updated
7-Dec-2016	Jamie Wilson	Condition check of known asbestos items	Annual site check - No deterioration to the condition of ACMs noted during the inspection
14-Jan-2016	Dave Kelly	Condition check of known asbestos items	Annual site check - No deterioration to the condition of ACMs noted during the inspection
10-Jul-2014	AMS 2000	Refurbishment & Demolition Survey	<p>The survey consist of a refurbishment demolition survey of the main hall area GD:0003 DP to confirm/ refute the presence of asbestos containing materials likely to be affected by the isolated refurbishment works as per the HSG 264 survey request form.</p> <p>The areas of works include:</p> <ol style="list-style-type: none"> 1. Isolation, removal and reinstatement of equipment/services attached to the ceiling in the Hall GD.0003. 2. Fix new insulation and plasterboard to the ceiling and around high level window reveals and hatches. Skim and decorate. <p>As well as the above works, an investigation was carried out of the main roof space area over the main hall areas to confirm/ refute the presence of any asbestos containing materials likely to be affected by the works.</p> <p>Lower block - Sealant used externally between frame removed</p> <p>The windows in the upper school are similar - therefore a strong assumption that they also contain chrysotile - added to register</p>
2-May-2014	Richard Boxall	ASB3 Form Return	

7-Jan-2014	Andrew Shaw	Condition check of known asbestos items	Annual site check - Items 633085 and 633078 noted as removed during the inspection. Work ongoing at time of inspection. Removed from register - ASB3 to follow completion of works.
14-Nov-2013	AMP team	Observation	Floor plan updates
27-Aug-2013	AMS 2000	Refurbishment & Demolition Survey	The survey consist of a refurbishment demolition survey of areas affected by the proposed window replacement works within the lower school building at the above address. The survey consist of an investigation of the ceiling, wall and window areas affected by the proposed works to confirm/ refute the presence of asbestos containing materials likely to be affected by the proposed works.
20-May-2013	Chris Haugh	ASB3 Form Return	Confirmation of asbestos removals GD.0026 - ceiling GD.0025-28 - roof slates GD.0021 - Splash back/wall panel/water tank panels/panels over lintel
30-Jan-2013	Warren Bonney	Condition check of known asbestos items	Annual site check - No deterioration to condition of ACMs noted during inspection
2-Nov-2012	AMP team	Observation	Floor plan update
3-Sep-2012	AMS 2000	Refurbishment & Demolition Survey	The survey consist of a refurbishment demolition survey of the ground floor main electrical cupboard area along with the external roof areas and wall areas affected by the proposed lightning and surge protection works only.
19-Mar-2012	Philip Jeffries	Condition check of known asbestos items	Annual site check - Items noted as removed 41,288, 41,289, 42,921 and 41,279. Items deteriorated from good - medium damage 41,289, 41,281. Items deteriorated from good - low damage 621,609, 621,610. Item deteriorated from low - medium damage 604,136
19-Oct-2011	Chris Haugh	ASB3 Form Return	Asbestos removed following scheme
24-Aug-2011	Nigel Coleman	ASB3 Form Return	Algorithm Update
1-May-2011	Technicon	Refurbishment & Demolition Survey	Additional survey information
23-Mar-2011	Ivor Oatway	Condition check of known asbestos items	Annual site check - Improvements made to register
22-Jun-2010	Technicon Ltd	Observation	Asbestos identified
1-Mar-2010	Ivor Oatway	Condition check of known asbestos items	Annual site check - Improvements made to register
11-Nov-2009	AMP Team	Observation	Register required update
8-Jun-2009	Shield Environmental	Initial Type 2 Survey	
9-Apr-2002	Dorset Soils and Materials Lab	Initial Type 2 Survey	

2. Executive Summary

NEWTOWN PRIMARY SCHOOL
CLIFTON ROAD
NEWTOWN
EXETER
EX1 2ES

2.1 Buildings on site

The following table displays details of each of the blocks on site and the construction details. The block reference should be used in conjunction with the survey details to locate elements on site

Reference	Block	Area (m2)	Construction
01	MAIN SCHOOL LOWER BLOCK	338	Permanent
02	MIDDLE BLOCK	491	Permanent
03	TOP BLOCK	158	Permanent
04	DOUBLE MODULAR BLOCK 2012	153	Wernick
50	OUTBUILDINGS	5	Outbuildings
51	PERMANENT OUTBUILDINGS	41	Outbuildings

2.2 Asbestos Summary

The following buildings have been identified as containing asbestos. Refer to DCC guidance on works involving licensed and unlicensed contractors.

For areas not listed below you need to confirm using the register that the area has been inspected. Note for any invasive works anywhere on the site you need to consider whether a refurbishment/ demolition survey is required due to the limitations of management surveys on which this register is based.

01	MAIN SCHOOL LOWER BLOCK
02	MIDDLE BLOCK
50	OUTBUILDINGS
51	PERMANENT OUTBUILDINGS

2.3 Summary of High and Medium Priority Risk Items

This list requires Review and Action by the Premise Manager.

There are no items.

3. Introduction

This document contains the asbestos register for your premises. The asbestos register is the written record of the location of known asbestos containing materials (ACMs) on your site. The register is compiled from information obtained from management surveys, additional samples information, inspections notifications from premises staff and, in some cases, surveys carried out prior to refurbishment and maintenance works.

The asbestos register is a “live” document and should be updated as and when asbestos containing materials (ACM's) undergo changes to their condition, when circumstances around the way the area is used alter or when additional ACM's are discovered.

This register is maintained by NPS South West Ltd. Any queries relating to the information contained within this register should be directed to the NPS South West Asset Management Team on 01392 351042.

Responsibilities

3.1. Premises Manager Responsibility

The person who is responsible for the management of the premises should be aware of their responsibilities as set out within the Devon County Council (DCC) Asbestos Policy and Guidance.

With particular reference to this register, premises managers should:

- Ensure that this register is the most up to date available. The most up to date copy of this register is available for printing from the Connect2 database.
- Understand the ‘survey limitations’
- Know the location and condition of all ACMs on their site and make this information available to anyone liable to disturb asbestos.
- Ask contractors to inspect the register and ensure that they understand their responsibilities whilst working on your site. It is advisable to document this by getting them to sign a suitable form which can be appended to this register.
- Ensure that actions in the management plan are undertaken.
- Ensure that monitoring is in place to manage the risks.
- Report to NPS any change in the condition of the ACMs (See DCC form ASB3).
- Notify NPS AMP Team of any works to the premises or changes of use that may affect the risk assessments and register.
- Ensure that fully intrusive survey work is undertaken prior to refurbishment or demolition work which shall include intrusive maintenance and repair work.
- Notify NPS of any ACMs or suspected ACMs found on site that are not listed in the asbestos register (See DCC form ASB3).
- Retain and maintain all records and documentation relating to the ACMs and works affecting the same.
- Ensure the annual inspection of all known ACMs by a competent person in order to monitor condition and review risk assessments and recommendations in the management plan.

Results from the annual inspection should be fed back into the register via the NPS Asset Management Team.

Note NPS surveyors where commissioned carry out annual inspections of ACM's, however this arrangement only covers properties within the corporate estate or where a school is buying into the Devon Maintenance Partnership or VA Promise Scheme.

3.2. Contractor Responsibility

All contractors carrying out building, engineering and maintenance work, which shall include servicing, testing and inspection, on DCC premises must strictly comply with the conditions of their contract in respect of asbestos and must:

- Inspect the asbestos register for the areas of the building where they will be working before commencing the works.
- Understand the 'survey limitations'
- Sign the asbestos register using the form appended to the register to confirm that they have been made aware of the locations of ACMs in the building. This form must be completed regardless of other signing in or site induction procedures.
- Ensure that their works will not disturb ACMs or presumed ACMs.
- Stop work immediately if they find materials on site that they suspect contain asbestos but are not on the register and inform the Premises Manager.

3.3. NPS Responsibility

NPS shall.

- Ensure that an asbestos register exists for all properties where Devon County council is the duty holder.
- Ensure that a fully intrusive survey is, where necessary, undertaken ahead of building and maintenance works under their control.
- Maintain the asbestos register, updating it when new information is received from surveys, inspections, and premise notifications. Providing a new copy of the register to the main contact for the premise as listed within Connect2.

Please note.

The content of the information provided by NPS is based upon asbestos surveys and inspections commissioned on behalf of Devon County Council (DCC) these have not been approved or verified by NPS with regard to their accuracy or completeness for the Sites to which they relate.

NPS are not responsible for the content of any information that is stored on Connect2 and printed in this register (unless that information consists of an inspection or survey produced or carried out by NPS) nor are we responsible for ensuring that such information is complete and kept up to date - all of which rests with the premises manager. Under no circumstances will NPS be responsible for the contents of, nor the operation of your Asbestos Management Plan.

Where NPS have been commissioned to provide condition inspections of known asbestos containing materials as identified within the "Asbestos register" please note that the inspection simply involves visiting [and inspecting] those previously identified items. No further validation of the Asbestos register is offered or liability accepted. Under no circumstances will we be liable if you fail to act on any recommendations or advice which we provide following those inspections.

3.4. Survey Limitations

This register is based on surveys which have been carried out by UKAS certified survey companies. Competent surveyors have made all reasonable efforts to identify ACMs in the buildings on your site without causing damage to the structural elements of the building fabric, fixtures and fittings. It should be noted that even when there is no asbestos found in any particular area this is not a guarantee that this location does not have asbestos present. Due caution must be taken when dealing with building materials and any suspected materials must be reported and left undisturbed until further investigation proves it safe to proceed. Not all ACMs in the register have been sampled. Materials will be marked as presumed where the surveyor has good cause to suspect asbestos but laboratory identification has not been undertaken to confirm this. Examples of this include the situation where there is similar material present throughout a building that has been sampled and confirmed to be asbestos in some places but not all. Materials that are presumed to contain asbestos are indicated in the asbestos register and in most cases the original sample number is provided and preceded by the letters As (sample reference). Work must not proceed on presumed ACMs unless by a licensed contractor or until the material has been sampled and identified by bulk analysis. If the suspected material tests positively for asbestos a method statement confirming how the work will proceed will be required as

above.

The majority of surveys carried out for DCC were to an MDHS100 specification which means that items which were not easily accessible are unlikely to have been inspected. The caveat below is typical limitations supplied by these companies in identifying areas that will not have been accessed.

1. The Survey was limited to those areas accessed at the time of survey.
2. Any areas or surfaces that would require the removal or relocation of carpets, furniture, blinds, curtains, fixtures and fittings were not inspected.
3. Lift shafts, plant room equipment or similar which would require the attendance of a specialist engineer have not been accessed
4. Flues, ducts, voids or any other similarly enclosed areas, the access to which necessitated the use of specialist equipment or tools or which would have caused damage to decoration, fixtures, fittings or the structure have not been accessed
5. Areas requiring specialist access equipment other than ladders were not inspected.
6. Concealed spaces that may exist within the fabric of the premises, where the extent of these is not evident due to inaccessibility or insufficient knowledge of the structure at the time of the survey, have not been reported on.
7. No responsibility is accepted for the presence of asbestos containing materials in voids (under-floor, floor, wall, ceiling, or roof) other than those opened during the survey.
8. Samples have not been taken where the act of sampling would endanger the Surveyor or affect the functional integrity of the item concerned, e.g. fuses within electrical distribution switch gear, certain gaskets, fire doors etc.
9. A limited inspection only has been carried out of pipework concealed by overlying non-asbestos insulation. Inspection of pipework has been restricted primarily to the insulation visible. The presence of debris to pipework, which is not readily visible or would require the removal and replacement of overlying non-asbestos insulation, has been considered outside the scope of this survey.

Areas indicated as not inspected should be treated as if they contain Asbestos. All buildings and rooms will have an entry indicating the outcome of the survey (within the limitations above). Any building or room without an entry should be considered as having not been inspected, and should be treated as if they contain asbestos.

Areas labelled none found indicate that no **visible** asbestos containing materials were identified within the area of inspection. However the survey limitations above should be clear enough as to indicate that this line should **not** be taken as an indication that no asbestos exists. Any planned work should be risk assessed and if appropriate a demolition survey organised.

Risk Assessments

3.5. Material Assessment

The register includes an assessment of the condition of each ACM and its ability to release fibres. The material assessment rating has been calculated according to four main parameters comprising product type; extent of damage and deterioration; surface treatment; and asbestos type. It does not automatically follow that those materials assigned the highest score in the material assessment will be the materials that should be given priority for remedial action.

3.6. Risk Assessment

The surveyor has established the likelihood of disturbance for each identified ACM by carrying out a priority risk assessment using the algorithm recommended in HSG227: Health and safety Guidance Booklet 227, A Comprehensive Guide to Managing Asbestos in Premises, HSE, 2002.

3.7. Overall Risk

The results of material and priority risk assessment are combined to calculate a total risk score and used to determine and confirm management actions. Total scores will fit in to one of four risk categories, High, Medium, Low or Very Low and are intended to flag to persons, not familiar with risk algorithms, an indication of the hazard associated with a particular ACM.

3.8. Management Plan Guidance

The asbestos register contains recommendations for managing each ACM. The management actions can be defined as follows:

Monitor and Manage: Leave the ACMs in place, monitor and record condition at intervals not exceeding 12 months. Labelling of materials on site should be considered on a local basis. Review action where deterioration or damage occurs.

Seal or Encapsulate: encapsulate surface of the ACM with a durable and flexible coating designed to give the ACM additional strength and prevent fibre release from surface of material. Suitable for ACMs that are presently unsealed and in reasonable condition. Not appropriate where material will be subject to impact damage and work in virtually all cases should be carried out by licensed contractor.

Protect or Enclose: Construct or place physical barrier to prevent damage to the ACM. If the works to provide the enclosure are liable to disturb the asbestos then a licensed asbestos removal contractor should carry out the work.

Repair: Suitable where damage is slight and repair is restricted to patching or making good small areas of material. A licensed contractor should generally undertake this work.

Remove: Where ACMs are not in good condition or are in a vulnerable position and liable to damage and it is not practicable to protect, seal or repair. Remove also in areas due for refurbishment, alterations or demolition. A licensed contractor should generally undertake this work. Works should be carried out as soon as is reasonably practicable.

Restrict Access: Where it is not possible to immediately repair or remove damaged asbestos and persons are likely to be exposed to asbestos fibres in the air. Restrict access to these spaces to persons with appropriate protective equipment.

3.9. Location Plans

Layout plans of the site and buildings will be included with this register. You should refer to these plans to ascertain the locations of known ACMs in the building. Plans may not be provided if there have been no ACMs identified on surveys or inspections.

3.10. Site Plans

Site plans will show the outlines of the buildings or blocks on the site. Areas of buildings outlined or hatched with red are known to contain materials that should generally be removed by a contractor holding a current licence granted by the Health and Safety Executive (HSE). Areas or buildings outlined or hatched in blue may have un accessed boxings, voids or rooms which should be treated as having asbestos containing materials.

3.11. Floor Plans

Floor plans, the room reference numbers annotated on the floor plans relates to the room reference numbers in the asbestos register. These plans are for reference purposes only and are generally only schematic.

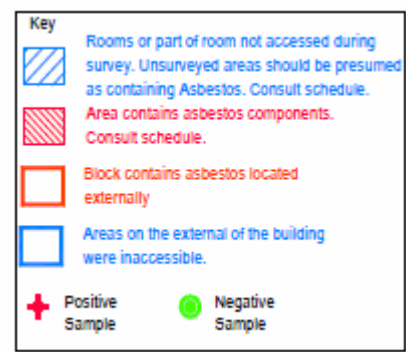

3.12. Premises where no ACMs have been identified

Management surveys of some premises built pre-1999 identified no ACMs. Undetected ACMs may exist in the premises and managers should continue to follow the available guidance on asbestos management and should still insist that contractors inspect and sign the asbestos register. Premises constructed post-1999 are highly unlikely to contain ACMs due to dates when use of asbestos was prohibited. Managers of premises constructed post-1999 are not required to ask contractors to inspect and sign asbestos registers in these buildings. If you are in any doubt as to the age of construction then you should presume that ACMs are present and do not proceed with intrusive works until a further survey has been carried out.

3.13. Further Information

Further guidance on asbestos management in Devon County Council (DCC) premises, including full details of legal requirements and responsibilities, can be obtained on the DCC intranet at

<https://staff.devon.gov.uk/er/healthsafetywellbeing/healthsafety/asbestos.htm>

or from your DCC Health and Safety Advisor. Further copies of asbestos registers can be obtained by accessing your site details at <https://concerto.nps.co.uk>.

If you have any about how to obtain or access registers on-line, please contact NPS AMP Team on 01392 351042. If you need advice on managing asbestos contact NPS Environmental Safety Manager on 01392 351041

3.14. Premises Transferred or Not under DCC Control

Where it is not responsible for the management of asbestos at the property Devon County Council accepts no responsibility for any loss or damage incurred as a result of any reliance on the information contained within the Asbestos Register. The duty holder for the purposes of the Control of Asbestos Regulations is advised to arrange their own Asbestos Survey in order to verify the accuracy or otherwise of this Asbestos Register.

In the event that the property to which this Asbestos Register relates transferred by Devon County Council to another organisation or individual ("the Transferee"), Devon County Council accepts no responsibility for any loss or damage incurred by the Transferee as a result of any reliance on the information contained within the Asbestos Register. The Transferee is advised to arrange their own Asbestos Survey in order to verify the accuracy or otherwise of this Asbestos Register.

4. Asbestos Register

Site 053801 : NEWTOWN PRIMARY SCHOOL

Building : 01 MAIN SCHOOL LOWER BLOCK

Floor :

Room:		Product type:	
Location:	Heater vent panel	Damage:	
	Floor : block level	Surface treatment:	
Use:	Heat source and services	Asbestos type:	No Asbestos Detected (0)
Reference:	132660	Extent:	
Sample number:	070	Material score:	
Presumed:	No	Priority score:	
N/A		Banding:	
Room:		Product type:	Composites(1)
Location:	Corrugated sheets	Damage:	Good-no damage (0)
	Position : Roof and ceiling Quantity : 0 to 10 m ² : Cement	Surface treatment:	Non friable composite asbestos (0)
Use:	Ceilings	Asbestos type:	Chrysotile (1)
Reference:	41288	Extent:	<=10m2 or <=10m pipe run
Sample number:	079	Material score:	
Presumed:	No	Priority score:	
REMOVED - (see annual site check 2012)		Banding:	
REMOVED			
Room:		Product type:	Composites(1)
Location:	Corrugated sheets	Damage:	Good-no damage (0)
	Position : Roof and ceiling Quantity : 0 to 10 m ² : Cement	Surface treatment:	Non friable composite asbestos (0)
Use:	Ceilings	Asbestos type:	Chrysotile (1)
Reference:	41289	Extent:	<=10m2 or <=10m pipe run
Sample number:	as-079	Material score:	
Presumed:	Yes	Priority score:	
REMOVED - (see annual site check 2012)		Banding:	
REMOVED			
Room:		Product type:	Composites(1)
Location:	Roof tiles, Room 11CW	Damage:	Low damage (1)
	Position : Roof Quantity : 10 to 100 m ² : Cement	Surface treatment:	Non friable composite asbestos (0)
Use:	Roofs	Asbestos type:	Chrysotile (1)
Reference:	42921	Extent:	>50m2 or >50m pipe run
Sample number:	069	Material score:	
Presumed:	No	Priority score:	
REMOVED - (see annual site check 2012)		Banding:	
REMOVED			

Site 053801 : NEWTOWN PRIMARY SCHOOL

Building : 01 MAIN SCHOOL LOWER BLOCK

Floor :



Room:
Location: Inner roof sheet over store GD-0026
Use: Reefs
Reference: 633056
Sample number: HRP0905114
Presumed: No
REMOVED (See ASB3 20/05/2013)

Product type: AIB,textiles,gaskets,ropes,paper(2)
Damage: Low damage (1)
Surface treatment: Enclosed sprays or lagging/bare-
cement (1)
Asbestos type: Chrysotile (1)
Extent: <=10m2 or <=10m pipe run
Material score:
Priority score:
Banding:

REMOVED

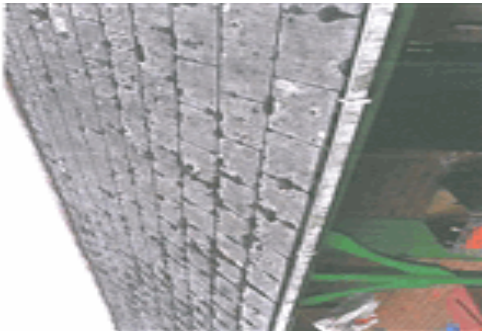

Room:
Location: Roof tile over store rooms GD-0025-28
Use: Reefs
Reference: 633057
Sample number: HRP0905113
Presumed: No
REMOVED (See ASB3 20/05/2013)

Product type: AIB,textiles,gaskets,ropes,paper(2)
Damage: Low damage (1)
Surface treatment: Enclosed sprays or lagging/bare-
cement (1)
Asbestos type: Chrysotile (1)
Extent: 10 to 50m2 or 10 to 50m pipe run
Material score:
Priority score:
Banding:

REMOVED

Room:
Location: Roofing tiles to main roof area.
Use: Roofs
Reference: 633061
Sample number: EC002143
Presumed: No
No further action required.

Product type:
Damage:
Surface treatment:
Asbestos type: No Asbestos Detected (0)
Extent:
Material score:
Priority score:
Banding:

Room:
Location: Bitumen roof felt to flat roof areas.
Use: Roof
Reference: 633062
Sample number: EC002144
Presumed: No
No further action required.

Product type:
Damage:
Surface treatment:
Asbestos type: No Asbestos Detected (0)
Extent:
Material score:
Priority score:
Banding:

Site 053801 : NEWTOWN PRIMARY SCHOOL

Building : 01 MAIN SCHOOL LOWER BLOCK

Floor :

Room:		Product type:	
Location:	Room 1 (High level Roofspace over hall) - Cement roof tiles and associated debris	Damage:	
Use:	Roof	Surface treatment:	
Reference:	633095	Asbestos type:	No Asbestos Detected (0)
Sample number:	EH002911	Extent:	
Presumed:	No	Material score:	
No further action required.		Priority score:	
		Banding:	

Room:		Product type:	
Location:	Room 1 (High level Roofspace over hall) - Felt to roof (rear elevations).	Damage:	
Use:	Roof	Surface treatment:	
Reference:	633096	Asbestos type:	No Asbestos Detected (0)
Sample number:	EH002912	Extent:	
Presumed:	No	Material score:	
No further action required.		Priority score:	
		Banding:	

Room:		Product type:	
Location:	Room 1 (High level Roofspace over hall) - Dust and debris sample 1.	Damage:	
Use:	Other	Surface treatment:	
Reference:	633098	Asbestos type:	No Asbestos Detected (0)
Sample number:	EH002914	Extent:	
Presumed:	No	Material score:	
No further action required.		Priority score:	
		Banding:	

Room:		Product type:	
Location:	Room 1 (High level Roofspace over hall) - Dust and debris sample 2.	Damage:	
Use:	Other	Surface treatment:	
Reference:	633099	Asbestos type:	No Asbestos Detected (0)
Sample number:	EH002915	Extent:	
Presumed:	No	Material score:	
No further action required.		Priority score:	
		Banding:	

Site 053801 : NEWTOWN PRIMARY SCHOOL

Building : 01 MAIN SCHOOL LOWER BLOCK

Floor :



Room:
Location: Room 1 (High level Roofspace over hall) -
Cement roof tiles and associated debris
Use: Roof
Reference: 633100
Sample number: EH002916
Presumed: No

Materials can be removed by a non-licensed
contractor in accordance with the Control of
Asbestos Regulations 2012.
No access during annual inspection

Product type: Composites(1)
Damage: Good-no damage (0)
Surface treatment: Enclosed sprays or lagging/bare
cement (1)
Asbestos type: Chrysotile (1)
Extent: >50m2 or >50m pipe run

Material score: 3
Priority score: 2
Banding: **Very Low**

Monitor & Manage

Room:
Location: Room 1 (High level Roofspace over hall) -
Textile rope .
Use: Textiles/cloth
Reference: 633102
Sample number: EH002917
Presumed: No

No further action required.

Product type:
Damage:
Surface treatment:

Asbestos type: No Asbestos Detected (0)
Extent:

Material score:
Priority score:
Banding:

Room:
Location: Room 1 (High level Roofspace over hall) -
High level panels above windows/walls
Use: Walls and partitions
Reference: 633103
Sample number: EH002918
Presumed: No

No further action required.

Product type:
Damage:
Surface treatment:

Asbestos type: No Asbestos Detected (0)
Extent:

Material score:
Priority score:
Banding:

Room:
Location: Cement Roof Tiles - Roof Gable 5

Use: Roof
Reference: 633146
Sample number: As 18204/BB/001
Presumed: Yes

Extent recorded is area affected by localised works

Product type:
Damage:
Surface treatment:

Asbestos type: No Asbestos Detected (0)
Extent:

Material score:
Priority score:
Banding:

Site 053801 : NEWTOWN PRIMARY SCHOOL

Building : 01 MAIN SCHOOL LOWER BLOCK

Floor :

Room:
Location: Cement Roof Tiles - Roof Gable 3

Use: Roof
Reference: 633148
Sample number: 18204/BB/001
Presumed: No

Extent recorded is area affected by localised works

Product type:
Damage:
Surface treatment:

Asbestos type: No Asbestos Detected (0)
Extent:

Material score:
Priority score:
Banding:

Room:
Location: Cement Roof Tiles - Roof Gable 10

Use: Roof
Reference: 633150
Sample number: 18204/BB/002
Presumed: No

Extent recorded is area affected by localised works

Product type:
Damage:
Surface treatment:

Asbestos type: No Asbestos Detected (0)
Extent:

Material score:
Priority score:
Banding:

Room:
Location: Cement Roof Tiles - Roof Gable 10

Use: Roof
Reference: 633154
Sample number: As 18204/BB/002
Presumed: Yes

Extent recorded is area affected by localised works

Product type:
Damage:
Surface treatment:

Asbestos type: No Asbestos Detected (0)
Extent:

Material score:
Priority score:
Banding:



Room: External
Location: Putty to windows throughout

Use: External walls, windows and doors
Reference: 633085
Sample number: EE000879
Presumed: No

REMOVED (See annual site check 07/01/2014)

Product type: Composites(1)
Damage: Good no damage (0)
Surface treatment: Non friable composite asbestos (0)

Asbestos type: Chrysotile (1)
Extent: 10 to 50m2 or 10 to 50m pipe run

Material score:
Priority score:
Banding:

REMOVED

Floor : Ground Floor

Site 053801 : NEWTOWN PRIMARY SCHOOL

Building : 01 MAIN SCHOOL LOWER BLOCK

Floor : Ground Floor

Room:	GD.0002 Resource Area (teaching)	Product type:	
Location:	Wall lining / core sample to area below window	Damage:	
Use:	Walls and partitions	Surface treatment:	
Reference:	633074	Asbestos type:	No Asbestos Detected (0)
Sample number:	EE000875	Extent:	
Presumed:	No	Material score:	
No further action required		Priority score:	
		Banding:	

Room:	GD.0012 Classroom	Product type:	
Location:	Panel behind heater	Damage:	
	Position : Wall	Surface treatment:	
Use:	Heat source and services	Asbestos type:	No Asbestos Detected (0)
Reference:	131634	Extent:	
Sample number:	056	Material score:	
Presumed:	No	Priority score:	
N/A		Banding:	

Room:	GD.0012 Classroom	Product type:	
Location:	Panel under heater	Damage:	
	Position : Floor	Surface treatment:	
Use:	Floors and stairs	Asbestos type:	No Asbestos Detected (0)
Reference:	41273	Extent:	
Sample number:	057	Material score:	
Presumed:	No	Priority score:	
N/A		Banding:	

Room:	GD.0012 Classroom	Product type:	
Location:	Floor panel	Damage:	
	Position : Floor	Surface treatment:	
Use:	Floors and stairs	Asbestos type:	No Asbestos Detected (0)
Reference:	41273	Extent:	
Sample number:	055	Material score:	
Presumed:	No	Priority score:	
N/A		Banding:	

Site 053801 : NEWTOWN PRIMARY SCHOOL

Building : 01 MAIN SCHOOL LOWER BLOCK

Floor : Ground Floor

Room:	GD.0012 Classroom	Product type:	
Location:	Wall panels behind cooker, outer layer	Damage:	
	Position : Wall	Surface treatment:	
Use:	Walls and partitions	Asbestos type:	No Asbestos Detected (0)
Reference:	41274	Extent:	
Sample number:	053		
Presumed:	No	Material score:	
		Priority score:	
N/A		Banding:	

Room:	GD.0012 Classroom	Product type:	
Location:	Wall panels behind cooker, inner layer	Damage:	
	Position : Wall	Surface treatment:	
Use:	Walls and partitions	Asbestos type:	No Asbestos Detected (0)
Reference:	41274	Extent:	
Sample number:	054		
Presumed:	No	Material score:	
		Priority score:	
N/A		Banding:	

Room:	GD.0013 Classroom	Product type:	
Location:	Panel under heater	Damage:	
	Position : Floor	Surface treatment:	
Use:	Floors and stairs	Asbestos type:	No Asbestos Detected (0)
Reference:	41275	Extent:	
Sample number:	058		
Presumed:	No	Material score:	
		Priority score:	
N/A		Banding:	

Room:	GD.0013 Classroom	Product type:	
Location:	Panel behind heater	Damage:	
	Position : Wall	Surface treatment:	
Use:	Heat source and services	Asbestos type:	No Asbestos Detected (0)
Reference:	41276	Extent:	
Sample number:	059		
Presumed:	No	Material score:	
		Priority score:	
N/A		Banding:	

Site 053801 : NEWTOWN PRIMARY SCHOOL

Building : 01 MAIN SCHOOL LOWER BLOCK

Floor : Ground Floor

Room: GD.0013 Classroom
Location: Ceiling board : N/A

Use: Ceilings
Reference: 633045
Sample number: HRP1506101
Presumed: No

No further action required

Product type:
Damage:
Surface treatment:

Asbestos type: No Asbestos Detected (0)
Extent:

Material score:
Priority score:
Banding:

Room: GD.0013 Classroom
Location: Fibreglass insulation above ceiling grid throughout
Use: Ceiling
Reference: 633076
Sample number: EE000876
Presumed: No

No further action required

Product type:
Damage:
Surface treatment:

Asbestos type: No Asbestos Detected (0)
Extent:

Material score:
Priority score:
Banding:

Room: GD.0013 Classroom
Location: Foil finish pipe insulation above suspended ceiling throughout
Use: Heat source and services
Reference: 633077
Sample number: EE000877
Presumed: No

No further action required

Product type:
Damage:
Surface treatment:

Asbestos type: No Asbestos Detected (0)
Extent:

Material score:
Priority score:
Banding:

Room: GD.0015 Girls Toilet
Location: Bitumen pad
 Position : Under sink
Use: Sanitary services
Reference: 41277
Sample number: 060
Presumed: No

N/A

Product type:
Damage:
Surface treatment:

Asbestos type: No Asbestos Detected (0)
Extent:

Material score:
Priority score:
Banding:

Site 053801 : NEWTOWN PRIMARY SCHOOL

Building : 01 MAIN SCHOOL LOWER BLOCK

Floor : Ground Floor

Room: GD.0019 Classroom
Location: Floor tiles
 Position : Floor
Use: Floors and stairs
Reference: 41278
Sample number: 061
Presumed: No

N/A

Product type:
Damage:
Surface treatment:

Asbestos type: No Asbestos Detected (0)
Extent:

Material score:
Priority score:
Banding:

Room: GD.0019 Classroom
Location: Backing board to heater : N/A

Use: Heat source and services
Reference: 633044
Sample number: HRP1106102
Presumed: No

No further action required

Product type:
Damage:
Surface treatment:

Asbestos type: No Asbestos Detected (0)
Extent:

Material score:
Priority score:
Banding:

Room: GD.0019 Classroom
Location: Backing board to heater : N/A

Use: Heat source and services
Reference: 633044
Sample number: HRP1106101
Presumed: No

No further action required

Product type:
Damage:
Surface treatment:

Asbestos type: No Asbestos Detected (0)
Extent:

Material score:
Priority score:
Banding:

Room: GD.0021 Classroom
Location: Panel behind heater and to right and below
 Position : Wall
Use: Heat source and services
Reference: 131635
Sample number: 066
Presumed: No

N/A

Product type:
Damage:
Surface treatment:

Asbestos type: No Asbestos Detected (0)
Extent:

Material score:
Priority score:
Banding:

Site 053801 : NEWTOWN PRIMARY SCHOOL

Building : 01 MAIN SCHOOL LOWER BLOCK

Floor : Ground Floor

Room:	GD.0021 Classroom	Product type:	
Location:	Rear panel behind heater	Damage:	
	Position : Wall	Surface treatment:	
Use:	Heat source and services	Asbestos type:	No Asbestos Detected (0)
Reference:	131635	Extent:	
Sample number:	062		
Presumed:	No	Material score:	
		Priority score:	
N/A		Banding:	

Room:	GD.0021 Classroom	Product type:	
Location:	Bottom panel behind heater	Damage:	
	Position : Wall	Surface treatment:	
Use:	Heat source and services	Asbestos type:	No Asbestos Detected (0)
Reference:	131635	Extent:	
Sample number:	063		
Presumed:	No	Material score:	
		Priority score:	
N/A		Banding:	

Room:	GD.0021 Classroom	Product type:	AIB, textiles, gaskets, ropes, paper(2)
Location:	Bitumen pad 0 to 10 m² : Well bound	Damage:	Good-no damage (0)
	Position : Under sink	Surface treatment:	Non friable composite asbestos (0)
Use:	Sanitary services	Asbestos type:	Chrysotile (1)
Reference:	41279	Extent:	<=10m2 or <=10m pipe run
Sample number:	065		
Presumed:	No	Material score:	
		Priority score:	
REMOVED - (see annual site check 2012)		Banding:	
		REMOVED	

Room:	GD.0021 Classroom	Product type:	
Location:	Lower base board below heater	Damage:	
	Position : Floor	Surface treatment:	
Use:	Heat source and services	Asbestos type:	No Asbestos Detected (0)
Reference:	41280	Extent:	
Sample number:	064		
Presumed:	No	Material score:	
		Priority score:	
N/A		Banding:	

Site 053801 : NEWTOWN PRIMARY SCHOOL

Building : 01 MAIN SCHOOL LOWER BLOCK

Floor : Ground Floor

Room: GD.0021 Classroom
Location: Tiles behind sink from heater to cupboard
Position : Wall
Use: Walls and partitions
Reference: 41281
Sample number: 067
Presumed: No
N/A

Product type:
Damage:
Surface treatment:
Asbestos type: No Asbestos Detected (0)
Extent:
Material score:
Priority score:
Banding:



Room: GD.0021 Classroom
Location: ~~Wall panel on chimney breast~~
~~Position :-~~
~~Wall~~
~~Quantity :- 0 to 10 m² :- Cement~~
Use: ~~Walls and partitions~~
Reference: 41281
Sample number: 068
Presumed: ~~No~~

REMOVED (See ASB3 19/10/2011)

Product type: ~~Composites(1)~~
Damage: ~~Medium damage (2)~~
Surface treatment: ~~Non friable composite asbestos (0)~~
Asbestos type: ~~Chrysotile (1)~~
Extent: ~~<=10m2 or <=10m pipe run~~

Material score:
Priority score:
Banding:

REMOVED

Room: GD.0021 Classroom
Location: Ceiling board : N/A
Use: Ceilings
Reference: 633046
Sample number: HRP1506102
Presumed: No

No further action required

Product type:
Damage:
Surface treatment:
Asbestos type: No Asbestos Detected (0)
Extent:

Material score:
Priority score:
Banding:

Room: GD.0021 Classroom
Location: ~~Floor tile :- Reinforced Composites~~
Use: ~~Floors and stairs~~
Reference: 633047
Sample number: HRP1506403
Presumed: ~~No~~

REMOVED (See ASB3 20/05/2013)

Product type: ~~Composites(1)~~
Damage: ~~Good no damage (0)~~
Surface treatment: ~~Non friable composite asbestos (0)~~
Asbestos type: ~~Chrysotile (1)~~
Extent: ~~10 to 50m2 or 10 to 50m pipe run~~

Material score:
Priority score:
Banding:

REMOVED

Site 053801 : NEWTOWN PRIMARY SCHOOL

Building : 01 MAIN SCHOOL LOWER BLOCK

Floor : Ground Floor



Room: GD.0021 Classroom
Location: Panel at high level
Use: Walls and partitions
Reference: 633052
Sample number: HRP0905144
Presumed: No
REMOVED (See ASB3 20/05/2013)

Product type: AIB,textiles,gaskets,ropes,paper(2)
Damage: Low damage (1)
Surface treatment: Enclosed sprays or lagging/bare-
cement (1)
Asbestos type: Chrysotile (1)
Extent: <=10m2 or <=10m pipe run
Material score:
Priority score:
Banding:

REMOVED



Room: GD.0021 Classroom
Location: Infill panel adj. boxed water tank
Use: Walls and partitions
Reference: 633053
Sample number: HRP0905142
Presumed: No
REMOVED (See ASB3 20/05/2013)

Product type: AIB,textiles,gaskets,ropes,paper(2)
Damage: Low damage (1)
Surface treatment: Enclosed sprays or lagging/bare-
cement (1)
Asbestos type: Chrysotile (1)
Extent: <=10m2 or <=10m pipe run
Material score:
Priority score:
Banding:

REMOVED



Room: GD.0021 Classroom
Location: Panel covering lintel
Use: Ceiling
Reference: 633054
Sample number:
Presumed: Yes
REMOVED (See ASB3 20/05/2013)

Product type: AIB,textiles,gaskets,ropes,paper(2)
Damage: Low damage (1)
Surface treatment: Enclosed sprays or lagging/bare-
cement (1)
Asbestos type: Chrysotile (1)
Extent: <=10m2 or <=10m pipe run
Material score:
Priority score:
Banding:

REMOVED



Room: GD.0021 Classroom
Location: Floor tile (on wall)
Use: Floors and stairs
Reference: 633055
Sample number: HRP1506403
Presumed: No
REMOVED (See ASB3 19/10/2011)

Product type: AIB,textiles,gaskets,ropes,paper(2)
Damage: Low damage (1)
Surface treatment: Enclosed sprays or lagging/bare-
cement (1)
Asbestos type: Chrysotile (1)
Extent: <=10m2 or <=10m pipe run
Material score:
Priority score:
Banding:

REMOVED

Site 053801 : NEWTOWN PRIMARY SCHOOL

Building : 01 MAIN SCHOOL LOWER BLOCK

Floor : Ground Floor



Room: GD.0021 Classroom
Location: Putty to all window surrounds of large metal-framed windows
Use: External walls, windows and doors
Reference: 633078
Sample number: EE000878
Presumed: No
REMOVED (See annual site check 07/01/2014)

Product type: Composites(1)
Damage: Good-no damage (0)
Surface treatment: Non friable composite asbestos (0)
Asbestos type: Chrysotile (1)
Extent: >50m2 or >50m pipe run
Material score:
Priority score:
Banding:
REMOVED

Building : 02 MIDDLE BLOCK

Floor :

Room:
Location: Roof tiles
Position : Roof
Use: Roofs
Reference: 42920
Sample number: 075
Presumed: No
N/A

Product type:
Damage:
Surface treatment:
Asbestos type: No Asbestos Detected (0)
Extent:
Material score:
Priority score:
Banding:

Room:
Location: Roofing tiles to main roof areas.
Use: Roofs
Reference: 633060
Sample number: EC002142
Presumed: No
No further action required.

Product type:
Damage:
Surface treatment:
Asbestos type: No Asbestos Detected (0)
Extent:
Material score:
Priority score:
Banding:

Room:
Location: Cement Roof Tiles - Roof
Use: Roof
Reference: 633139
Sample number: 08679/LJ/001
Presumed: No
No further action required

Product type:
Damage:
Surface treatment:
Asbestos type: No Asbestos Detected (0)
Extent:
Material score:
Priority score:
Banding:

Site 053801 : NEWTOWN PRIMARY SCHOOL

Building : 02 MIDDLE BLOCK

Floor :

Room:		Product type:	
Location:	Putty - Rainwater Goods	Damage:	
Use:	Drainage	Surface treatment:	
Reference:	633140	Asbestos type:	No Asbestos Detected (0)
Sample number:	08679/LJ/002	Extent:	
Presumed:	No	Material score:	
No further action required		Priority score:	
		Banding:	

Room:	External	Product type:	
Location:	Damp proof course to all perimeter walls	Damage:	
Use:	External walls, windows and doors	Surface treatment:	
Reference:	633123	Asbestos type:	No Asbestos Detected (0)
Sample number:	18	Extent:	
Presumed:	No	Material score:	
No further action required		Priority score:	
		Banding:	

Floor : Ground Floor

Room:	GD.0003 Multi Use Hall	Product type:	
Location:	Panels behind and under heater Position : Heater	Damage:	
Use:	Heat source and services	Surface treatment:	
Reference:	44713	Asbestos type:	No Asbestos Detected (0)
Sample number:	071	Extent:	
Presumed:	No	Material score:	
N/A		Priority score:	
		Banding:	

Room:	GD.0003 Multi Use Hall	Product type:	
Location:	Ceiling lining	Damage:	
Use:	Ceiling	Surface treatment:	
Reference:	633089	Asbestos type:	No Asbestos Detected (0)
Sample number:	ED003094	Extent:	
Presumed:	No	Material score:	
No further action required		Priority score:	
		Banding:	

Site 053801 : NEWTOWN PRIMARY SCHOOL

Building : 02 MIDDLE BLOCK

Floor : Ground Floor

Room:	GD.0003 Multi Use Hall	Product type:	
Location:	Bitumen adhesive to parquet flooring	Damage:	
Use:	Floors and stairs	Surface treatment:	
Reference:	633090	Asbestos type:	No Asbestos Detected (0)
Sample number:	ED003095	Extent:	
Presumed:	No	Material score:	
No further action required		Priority score:	
		Banding:	

Room:	GD.0003 Multi Use Hall	Product type:	
Location:	Insulating board panels behind and below heater	Damage:	
Use:	Other	Surface treatment:	
Reference:	633091	Asbestos type:	No Asbestos Detected (0)
Sample number:	ED003096	Extent:	
Presumed:	No	Material score:	
No further action required		Priority score:	
		Banding:	

Room:	GD.0003 Multi Use Hall	Product type:	
Location:	Putty to gothic style windows	Damage:	
Use:	Windows and doors	Surface treatment:	
Reference:	633092	Asbestos type:	No Asbestos Detected (0)
Sample number:	ED003097	Extent:	
Presumed:	No	Material score:	
No further action required		Priority score:	
		Banding:	

Room:	GD.0003 Multi Use Hall	Product type:	
Location:	Adhesive between parquet flooring blocks	Damage:	
Use:	Floors and stairs	Surface treatment:	
Reference:	633114	Asbestos type:	No Asbestos Detected (0)
Sample number:	9	Extent:	
Presumed:	No	Material score:	
No further action required		Priority score:	
		Banding:	

Site 053801 : NEWTOWN PRIMARY SCHOOL

Building : 02 MIDDLE BLOCK

Floor : Ground Floor

Room:	GD.0003 Multi Use Hall	Product type:	
Location:	Panels to rear of wall mounted gas heater	Damage:	
Use:	Heat source and services	Surface treatment:	
Reference:	633115	Asbestos type:	No Asbestos Detected (0)
Sample number:	10	Extent:	
Presumed:	No	Material score:	
No further action required		Priority score:	
		Banding:	

Room:	GD.0003 Multi Use Hall	Product type:	
Location:	Panels below wall mounted gas heater	Damage:	
Use:	Heat source and services	Surface treatment:	
Reference:	633133	Asbestos type:	No Asbestos Detected (0)
Sample number:	as 6	Extent:	
Presumed:	Yes	Material score:	
No further action required		Priority score:	
		Banding:	

Room:	GD.0003 Multi Use Hall	Product type:	
Location:	Bitumen adhesive beneath parquet flooring	Damage:	
Use:	Floors and stairs	Surface treatment:	
Reference:	633142	Asbestos type:	No Asbestos Detected (0)
Sample number:	AN002306	Extent:	
Presumed:	No	Material score:	
No further action required		Priority score:	
		Banding:	

Room:	GD.0004 Servery	Product type:	
Location:	Biutmen pad Position : Under sink	Damage:	
Use:	Sanitary services	Surface treatment:	
Reference:	41283	Asbestos type:	No Asbestos Detected (0)
Sample number:	072	Extent:	
Presumed:	No	Material score:	
N/A		Priority score:	
		Banding:	

Site 053801 : NEWTOWN PRIMARY SCHOOL

Building : 02 MIDDLE BLOCK

Floor : Ground Floor

Room: GD.0004 Servery
Location: Flooring beneath modern lino

Use: Floors and stairs
Reference: 633120
Sample number: 15
Presumed: No

No further action required

Product type:
Damage:
Surface treatment:

Asbestos type: No Asbestos Detected (0)
Extent:

Material score:
Priority score:
Banding:

Room: GD.0004 Servery
Location: Damper pad beneath small sink

Use: Other
Reference: 633126
Sample number: as 2
Presumed: Yes

No further action required

Product type:
Damage:
Surface treatment:

Asbestos type: No Asbestos Detected (0)
Extent:

Material score:
Priority score:
Banding:

Room: GD.0004 Servery
Location: Pin boards to walls

Use: Other
Reference: 633128
Sample number: as 3
Presumed: Yes

No further action required

Product type:
Damage:
Surface treatment:

Asbestos type: No Asbestos Detected (0)
Extent:

Material score:
Priority score:
Banding:

Room: GD.0004 Servery
Location: Sarking felt to roof above ceiling

Use: Roofs
Reference: 633130
Sample number: as 4
Presumed: Yes

No further action required

Product type:
Damage:
Surface treatment:

Asbestos type: No Asbestos Detected (0)
Extent:

Material score:
Priority score:
Banding:

Site 053801 : NEWTOWN PRIMARY SCHOOL

Building : 02 MIDDLE BLOCK

Floor : Ground Floor

Room:	GD.0004 Servery	Product type:	
Location:	Panels to rear of wall mounted gas heater	Damage:	
Use:	Heat source and services	Surface treatment:	
Reference:	633131	Asbestos type:	No Asbestos Detected (0)
Sample number:	as 5	Extent:	
Presumed:	Yes		
No further action required		Material score:	
		Priority score:	
		Banding:	

Room:	GD.0004 Servery	Product type:	
Location:	Panels beneath wall mounted gas heater	Damage:	
Use:	Heat source and services	Surface treatment:	
Reference:	633134	Asbestos type:	No Asbestos Detected (0)
Sample number:	as 6	Extent:	
Presumed:	Yes		
No further action required		Material score:	
		Priority score:	
		Banding:	

Room:	GD.0004A Kitchen Store	Product type:	
Location:	Biutmen padPosition : Under sinkQuantity : N/A to N/A N/A : N/A	Damage:	
Use:	Sanitary services	Surface treatment:	
Reference:	633155	Asbestos type:	No Asbestos Detected (0)
Sample number:	072	Extent:	
Presumed:	No		
Copied from room split		Material score:	
		Priority score:	
		Banding:	

Room:	GD.0004A Kitchen Store	Product type:	
Location:	Flooring beneath modern lino	Damage:	
Use:	Floors and stairs	Surface treatment:	
Reference:	633156	Asbestos type:	No Asbestos Detected (0)
Sample number:	15	Extent:	
Presumed:	No		
No further action required		Material score:	
Copied from room split		Priority score:	
		Banding:	

Site 053801 : NEWTOWN PRIMARY SCHOOL

Building : 02 MIDDLE BLOCK

Floor : Ground Floor

Room: GD.0004A Kitchen Store
Location: Damper pad beneath small sink

Use: Other
Reference: 633157
Sample number: as 2
Presumed: Yes

No further action required
Copied from room split

Product type:
Damage:
Surface treatment:

Asbestos type: No Asbestos Detected (0)
Extent:

Material score:
Priority score:
Banding:

Room: GD.0004A Kitchen Store
Location: Pin boards to walls

Use: Other
Reference: 633158
Sample number: as 3
Presumed: Yes

No further action required
Copied from room split

Product type:
Damage:
Surface treatment:

Asbestos type: No Asbestos Detected (0)
Extent:

Material score:
Priority score:
Banding:

Room: GD.0004A Kitchen Store
Location: Sarking felt to roof above ceiling

Use: Roofs
Reference: 633159
Sample number: as 4
Presumed: Yes

No further action required
Copied from room split

Product type:
Damage:
Surface treatment:

Asbestos type: No Asbestos Detected (0)
Extent:

Material score:
Priority score:
Banding:

Room: GD.0004A Kitchen Store
Location: Panels to rear of wall mounted gas heater

Use: Heat source and services
Reference: 633160
Sample number: as 5
Presumed: Yes

No further action required
Copied from room split

Product type:
Damage:
Surface treatment:

Asbestos type: No Asbestos Detected (0)
Extent:

Material score:
Priority score:
Banding:

Site 053801 : NEWTOWN PRIMARY SCHOOL

Building : 02 MIDDLE BLOCK

Floor : Ground Floor

Room:	GD.0004A Kitchen Store	Product type:	
Location:	Panels beneath wall mounted gas heater	Damage:	
Use:	Heat source and services	Surface treatment:	
Reference:	633161	Asbestos type:	No Asbestos Detected (0)
Sample number:	as 6	Extent:	
Presumed:	Yes	Material score:	
No further action required		Priority score:	
Copied from room split		Banding:	

Room:	GD.0005 Cloakroom	Product type:	
Location:	Textured ceiling	Damage:	
	Position : Ceiling	Surface treatment:	
Use:	Ceilings	Asbestos type:	No Asbestos Detected (0)
Reference:	41284	Extent:	
Sample number:	073	Material score:	
Presumed:	No	Priority score:	
N/A		Banding:	



Room:	GD.0007 Special Educational Needs	Product type:	Composites(1)
Location:	Textured coating above ceiling tiles	Damage:	Low damage (1)
Use:	Ceiling	Surface treatment:	Enclosed sprays or lagging/bare cement (1)
Reference:	633116	Asbestos type:	Chrysotile (1)
Sample number:	11	Extent:	10 to 50m2 or 10 to 50m pipe run
Presumed:	No	Material score:	4
Work with this material to be carried out in accordance with the Control of Asbestos Regulations 2012		Priority score:	6
No access during annual inspection		Banding:	Low
		Monitor & Manage	

Room:	GD.0007 Special Educational Needs	Product type:	
Location:	Night storage heater internals / insulation behind panel	Damage:	
Use:	Heat source and services	Surface treatment:	
Reference:	633117	Asbestos type:	No Asbestos Detected (0)
Sample number:	12	Extent:	
Presumed:	No	Material score:	
No further action required		Priority score:	
		Banding:	

Site 053801 : NEWTOWN PRIMARY SCHOOL

Building : 02 MIDDLE BLOCK

Floor : Ground Floor

Room:	GD.0007 Special Educational Needs	Product type:	
Location:	Night storage heater internals / loose insulation around fire bricks	Damage:	
Use:	Heat source and services	Surface treatment:	
Reference:	633118	Asbestos type:	No Asbestos Detected (0)
Sample number:	13	Extent:	
Presumed:	No	Material score:	
No further action required		Priority score:	
		Banding:	

Room:	GD.0007 Special Educational Needs	Product type:	
Location:	Night storage heater internals / insulation board beneath fire bricks	Damage:	
Use:	Heat source and services	Surface treatment:	
Reference:	633119	Asbestos type:	No Asbestos Detected (0)
Sample number:	14	Extent:	
Presumed:	No	Material score:	
No further action required		Priority score:	
		Banding:	

Room:	GD.0007 Special Educational Needs	Product type:	
Location:	Black skirting	Damage:	
Use:	Floors and stairs	Surface treatment:	
Reference:	633136	Asbestos type:	No Asbestos Detected (0)
Sample number:	as 8	Extent:	
Presumed:	Yes	Material score:	
No further action required		Priority score:	
		Banding:	

Room:	GD.0012 Classroom	Product type:	
Location:	Damper pad beneath sink	Damage:	
Use:	Other	Surface treatment:	
Reference:	633127	Asbestos type:	No Asbestos Detected (0)
Sample number:	as 2	Extent:	
Presumed:	Yes	Material score:	
No further action required		Priority score:	
		Banding:	

Site 053801 : NEWTOWN PRIMARY SCHOOL

Building : 02 MIDDLE BLOCK

Floor : Ground Floor

Room:	GD.0012 Classroom	Product type:	
Location:	Panels to rear of wall mounted gas heater	Damage:	
Use:	Heat source and services	Surface treatment:	
Reference:	633132	Asbestos type:	No Asbestos Detected (0)
Sample number:	as 5	Extent:	
Presumed:	Yes		
No further action required		Material score:	
		Priority score:	
		Banding:	

Room:	GD.0012 Classroom	Product type:	
Location:	Panels beneath wall mounted gas heater	Damage:	
Use:	Heat source and services	Surface treatment:	
Reference:	633135	Asbestos type:	No Asbestos Detected (0)
Sample number:	as 6	Extent:	
Presumed:	Yes		
No further action required		Material score:	
		Priority score:	
		Banding:	

Room:	GD.0013 Staff Toilet	Product type:	
Location:	Black skirting	Damage:	
Use:	Floors and stairs	Surface treatment:	
Reference:	633113	Asbestos type:	No Asbestos Detected (0)
Sample number:	8	Extent:	
Presumed:	No		
No further action required		Material score:	
		Priority score:	
		Banding:	

Room:	GD.0016 Staff Room	Product type:	
Location:	Sarking felt to roof above ceiling	Damage:	
Use:	Roofs	Surface treatment:	
Reference:	633109	Asbestos type:	No Asbestos Detected (0)
Sample number:	4	Extent:	
Presumed:	No		
No further action required		Material score:	
		Priority score:	
		Banding:	

Site 053801 : NEWTOWN PRIMARY SCHOOL

Building : 02 MIDDLE BLOCK

Floor : Ground Floor

Room:	GD.0016 Staff Room	Product type:	
Location:	Panels to rear of wall mounted gas heater	Damage:	
Use:	Heat source and services	Surface treatment:	
Reference:	633110	Asbestos type:	No Asbestos Detected (0)
Sample number:	5	Extent:	
Presumed:	No	Material score:	
No further action required		Priority score:	
		Banding:	

Room:	GD.0016 Staff Room	Product type:	
Location:	Panels below wall mounted gas heater	Damage:	
Use:	Heat source and services	Surface treatment:	
Reference:	633111	Asbestos type:	No Asbestos Detected (0)
Sample number:	6	Extent:	
Presumed:	No	Material score:	
No further action required		Priority score:	
		Banding:	

Room:	GD.0016 Staff Room	Product type:	
Location:	Pin board to wall with gas heater	Damage:	
Use:	Other	Surface treatment:	
Reference:	633129	Asbestos type:	No Asbestos Detected (0)
Sample number:	as 3	Extent:	
Presumed:	Yes	Material score:	
No further action required		Priority score:	
		Banding:	

Room:	GD.0017 Resource Area (teaching)	Product type:	
Location:	Bitumen pad Position : Under sink	Damage:	
Use:	Sanitary services	Surface treatment:	
Reference:	41285	Asbestos type:	No Asbestos Detected (0)
Sample number:	074	Extent:	
Presumed:	No	Material score:	
N/A		Priority score:	
		Banding:	

Site 053801 : NEWTOWN PRIMARY SCHOOL

Building : 02 MIDDLE BLOCK

Floor : Ground Floor

Room: GD.0018 Classroom
Location: Damper pad beneath sink

Use: Other
Reference: 633107
Sample number: 2
Presumed: No

No further action required

Product type:
Damage:
Surface treatment:

Asbestos type: No Asbestos Detected (0)
Extent:

Material score:
Priority score:
Banding:

Room: GD.0018 Classroom
Location: Pin board to wall with gas heater

Use: Other
Reference: 633108
Sample number: 3
Presumed: No

No further action required

Product type:
Damage:
Surface treatment:

Asbestos type: No Asbestos Detected (0)
Extent:

Material score:
Priority score:
Banding:

Room: GD.0018 Classroom
Location: Window putty to high level glazing above
 partition to hall
Use: Windows and doors
Reference: 633112
Sample number: 7
Presumed: No

No further action required

Product type:
Damage:
Surface treatment:

Asbestos type: No Asbestos Detected (0)
Extent:

Material score:
Priority score:
Banding:

Room: GD.0025 Conference/Interview Room
Location: Panel to roof void hatch above ceiling tiles

Use: Other
Reference: 633106
Sample number: 1
Presumed: No

No further action required

Product type:
Damage:
Surface treatment:

Asbestos type: No Asbestos Detected (0)
Extent:

Material score:
Priority score:
Banding:

Site 053801 : NEWTOWN PRIMARY SCHOOL

Building : 02 MIDDLE BLOCK

Floor : Ground Floor

Room: GD.0025A Store/cupboard
Location: Panel to roof void hatch above ceiling tiles
Use: Other
Reference: 633163
Sample number: 1
Presumed: No
No further action required
Copied from room split

Product type:
Damage:
Surface treatment:
Asbestos type: No Asbestos Detected (0)
Extent:
Material score:
Priority score:
Banding:



Room: GD.0026 Entrance Step Area
Location: Soffit
Use: Roofs
Reference: 621609
Sample number:
Presumed: Yes
Exercise caution until content established

Product type: AIB,textiles,gaskets,ropes,paper(2)
Damage: Low damage (1)
Surface treatment: Non friable composite asbestos (0)
Asbestos type: Crocidolite (3)
Extent: <=10m2 or <=10m pipe run
Material score: 6
Priority score: 4
Banding: Low

Monitor & Manage



Room: GD.0027 Access Ramp
Location: Soffit
Use: Roofs
Reference: 621610
Sample number:
Presumed: Yes
Exercise caution until content established

Product type: AIB,textiles,gaskets,ropes,paper(2)
Damage: Low damage (1)
Surface treatment: Enclosed sprays or lagging/bare cement (1)
Asbestos type: Crocidolite (3)
Extent: 10 to 50m2 or 10 to 50m pipe run
Material score: 7
Priority score: 4
Banding: Low

Monitor & Manage

Building : 03 TOP BLOCK

Floor :

Room:
Location: Putty to all window surrounds of large metal-framed windows
Use: External walls, windows and doors
Reference: 633087
Sample number: As EE000878
Presumed: Yes
REMOVED (See ASB3 14/10/2020)

Product type: Composites(1)
Damage: Good no damage (0)
Surface treatment: Non friable composite asbestos (0)
Asbestos type: Chrysotile (1)
Extent: >50m2 or >50m pipe run
Material score:
Priority score:
Banding:

REMOVED

Site 053801 : NEWTOWN PRIMARY SCHOOL

Building : 03 TOP BLOCK

Floor :

Room:	External	Product type:	Composites(1)
Location:	Putty to windows throughout	Damage:	Good-no damage (0)
Use:	External walls, windows and doors	Surface treatment:	Non friable composite asbestos (0)
Reference:	633088	Asbestos type:	Chrysotile (1)
Sample number:	As EE000879	Extent:	10 to 50m2 or 10 to 50m pipe run
Presumed:	Yes	Material score:	
REMOVED (See ASB3 14/10/20)		Priority score:	
		Banding:	
			REMOVED

Floor : 1st Floor

Room:	01.0002 Classroom	Product type:	
Location:	Bitumen pad	Damage:	
Position :	Under sink	Surface treatment:	
Use:	Sanitary services	Asbestos type:	No Asbestos Detected (0)
Reference:	41286	Extent:	
Sample number:	077	Material score:	
Presumed:	No	Priority score:	
N/A		Banding:	

Room:	01.0002 Classroom	Product type:	
Location:	Panel behind heater	Damage:	
Position :	Wall	Surface treatment:	
Use:	Heat source and services	Asbestos type:	No Asbestos Detected (0)
Reference:	41287	Extent:	
Sample number:	078	Material score:	
Presumed:	No	Priority score:	
N/A		Banding:	

Building : 51 PERMANENT OUTBUILDINGS

Floor :



Room:	CW - GD.0002 Roof only	Product type:	Composites(1)
Location:		Damage:	Good-no damage (0)
Use:	Roofs	Surface treatment:	Non friable composite asbestos (0)
Reference:	604136	Asbestos type:	Chrysotile (1)
Sample number:	076	Extent:	>50m2 or >50m pipe run
Presumed:	No	Material score:	2
Moss covered		Priority score:	6
		Banding:	Very Low
			Monitor & Manage

Site 053801 : NEWTOWN PRIMARY SCHOOL

Building : 51 PERMANENT OUTBUILDINGS

Floor :



Room: External
Location: Cement roof tiles
Use: Roofs
Reference: 633122
Sample number: 47
Presumed: No
PE Shed roof REMOVED (See ASB3 14/10/2020)

Product type: Composites(1)
Damage: Low damage (1)
Surface treatment: Enclosed sprays or lagging/bare cement (1)
Asbestos type: Chrysotile (1)
Extent: >50m2 or >50m pipe run
Material score:
Priority score:
Banding:

REMOVED

Floor : Ground Floor



Room: GD.0002 Meter Room
Location: Corrugated sheets Position : Roof and ceiling Quantity : 0 to 10 m² : Cement
Use: Ceilings
Reference: 41289
Sample number: 080
Presumed: No
REMOVED (See ASB3 19/10/2011)

Product type: Composites(1)
Damage: Medium damage (2)
Surface treatment: Non friable composite asbestos (0)
Asbestos type: Chrysotile (1)
Extent: <=10m2 or <=10m pipe run
Material score:
Priority score:
Banding:

REMOVED



Room: GD.0002 Meter Room
Location: Bitumen coated textile wrapped mains cable - No sample as live.
Use: Electrical Services
Reference: 633058
Sample number:
Presumed: Yes
Materials can be removed by a non-licensed contractor in accordance with the Control of Asbestos Regulations 2012.

Product type: AIB,textiles,gaskets,ropes,paper(2)
Damage: Good-no damage (0)
Surface treatment: Enclosed sprays or lagging/bare cement (1)
Asbestos type: Chrysotile (1)
Extent: <=10m2 or <=10m pipe run
Material score: 4
Priority score: 4
Banding: Very Low

Monitor & Manage

Room: GD.0002 Meter Room
Location: Packing beneath brick wall
Use: Walls and partitions
Reference: 633121
Sample number: 16
Presumed: No
No further action required

Product type:
Damage:
Surface treatment:
Asbestos type: No Asbestos Detected (0)
Extent:
Material score:
Priority score:
Banding:

Site 053801 : NEWTOWN PRIMARY SCHOOL

Building : 51 PERMANENT OUTBUILDINGS

Floor : Ground Floor



Room: GD.0002 Meter Room
Location: Electrical intake wrapping
Use: Other
Reference: 633137
Sample number: P1
Presumed: No

Not safe to sample. Presumed to contain asbestos. Work with this material to be carried out in accordance with the Control of Asbestos Regulations 2012

Product type: Composites(1)
Damage: Low damage (1)
Surface treatment: Non friable composite asbestos (0)
Asbestos type: Chrysotile (1)
Extent: <=10m2 or <=10m pipe run
Material score: 3
Priority score: 3
Banding: Very Low

Monitor & Manage



Room: GD.0002 Meter Room
Location: Proiled roof sheets
Use: Roofs
Reference: 633138
Sample number: SP1 (prev EC002141)
Presumed: No

Strongly presumed to contain asbestos. Work with this material to be carried out in accordance with the Control of Asbestos Regulations 2012
Moss covered (See annual site check)

Product type: Composites(1)
Damage: Medium damage (2)
Surface treatment: Enclosed sprays or lagging/bare cement (1)
Asbestos type: Chrysotile (1)
Extent: 10 to 50m2 or 10 to 50m pipe run
Material score: 5
Priority score: 4
Banding: Low

Monitor & Manage



Room: GD.0004 P E Store
Location: Cement roof tiles
Use: Roofs
Reference: 633125
Sample number: as 47
Presumed: Yes

REMOVED (See annual site check 2019)

Product type: Composites(1)
Damage: Low damage (1)
Surface treatment: Enclosed sprays or lagging/bare cement (1)
Asbestos type: Chrysotile (1)
Extent: 10 to 50m2 or 10 to 50m pipe run
Material score:
Priority score:
Banding:

REMOVED

5.0 Areas Not Inspected

Management surveys will involve only minor intrusive work. Surveys have been carried out on behalf of DCC by various UKAS accredited survey companies. The caveat below is typical limitations supplied by these companies in identifying areas that are will not have been accessed.

1. The Survey was limited to those areas accessed at the time of survey.
2. Any areas or surfaces that would require the removal or relocation of carpets, furniture, blinds, curtains, fixtures and fittings were not inspected.
3. Lift shafts, plant room equipment or similar which would require the attendance of a specialist engineer have not been accessed
4. Flues, ducts, voids or any other similarly enclosed areas, the access to which necessitated the use of specialist equipment or tools or which would have caused damage to decoration, fixtures, fittings or the structure have not been accessed
5. Areas requiring specialist access equipment other than ladders were not inspected.
6. Concealed spaces that may exist within the fabric of the premises, where the extent of these is not evident due to inaccessibility or insufficient knowledge of the structure at the time of the survey, have not been reported on.
7. No responsibility is accepted for the presence of asbestos containing materials in voids (under-floor, floor, wall, ceiling, or roof) other than those opened during the survey.
8. Samples have not been taken where the act of sampling would endanger the Surveyor or affect the functional integrity of the item concerned, e.g. fuses within electrical distribution switch gear, certain gaskets, fire doors etc.
9. A limited inspection only has been carried out of pipework concealed by overlying non-asbestos insulation. Inspection of pipework has been restricted primarily to the insulation visible. The presence of debris to pipework, which is not readily visible or would require the removal and replacement of overlying non-asbestos insulation, has been considered outside the scope of this survey.

Areas not inspected should be treated as if they contain Asbestos.

Areas not inspected

This section should be read in conjunction with the survey limitations'

Location	Comment
01 MAIN SCHOOL LOWER BLOCK	
: Room 1 (High level Roofspace over hall). - No access within roofspace areas that lead off from main roofspace.	Inaccessible Building/ Room/ space Further Inspection Required
04 DOUBLE MODULAR BLOCK 2012	
GD.0001 Covered Area :	Not inspected. Age presumes none.
GD.0002 Lobby :	Not inspected. Age presumes none.
GD.0003 Covered Area :	Not inspected. Age presumes none.
GD.0004 Classroom :	Not inspected. Age presumes none.
GD.0005 Entrance Step Area :	Not inspected. Age presumes none.
GD.0006 Store/cupboard :	Not inspected. Age presumes none.
GD.0007 Infants Toilet (shared) :	Not inspected. Age presumes none.
GD.0008 Disabled Persons Toilet :	Not inspected. Age presumes none.
GD.0009 Classroom :	Not inspected. Age presumes none.
GD.0010 Store/cupboard :	Not inspected. Age presumes none.
GD.0011 Entrance Step Area :	Not inspected. Age presumes none.



Key

Rooms or part of room not accessed during survey. Unsurveyed areas should be presumed as containing Asbestos. Consult schedule.

Area contains asbestos components. Consult schedule.

Block contains asbestos located externally

Areas on the external of the building were inaccessible.

Positive Sample

Negative Sample

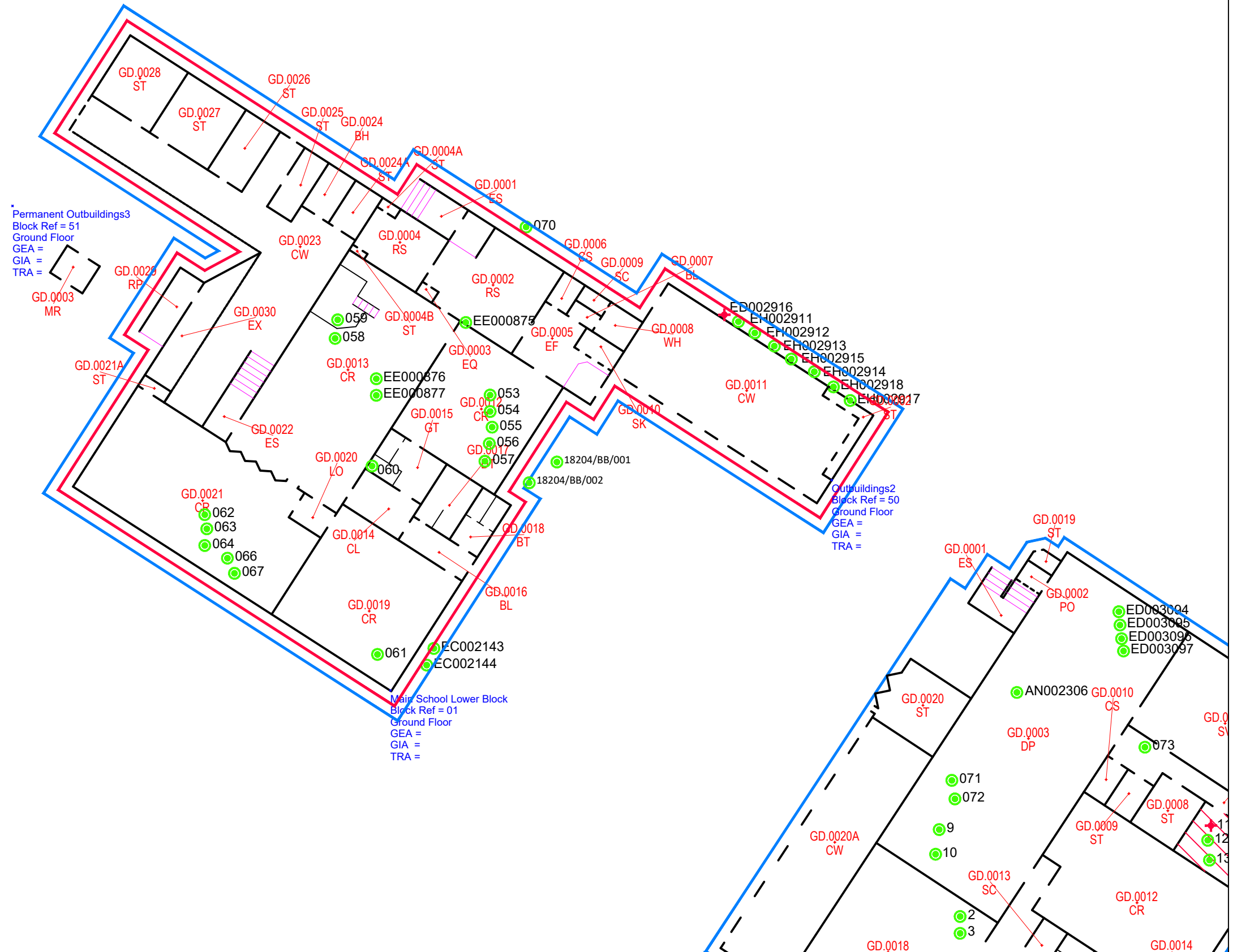

Ground Floor

<div><div>Devon</div><div>County Council</div></div> <div>County Hall, Topsham Road, Exeter, EX2 4QG 01392 384392</div> <div><div>nps</div><div>group</div></div> <div>NPS South West Capital Court Bittern Road Sowton Exeter EX2 7FW 01392 351042</div>	B.I.S. No.	0538	DCSF No	2029	Name Newtown Primary School	
	Address Newtown Primary School Clifton Road, Newtown Exeter Devon		Dept. CYPs		Drawn by	CPlant
			Tel: 01392 255540		Date	24/05/2022
			Scale NTS		Sheet	ASB 1 of 3

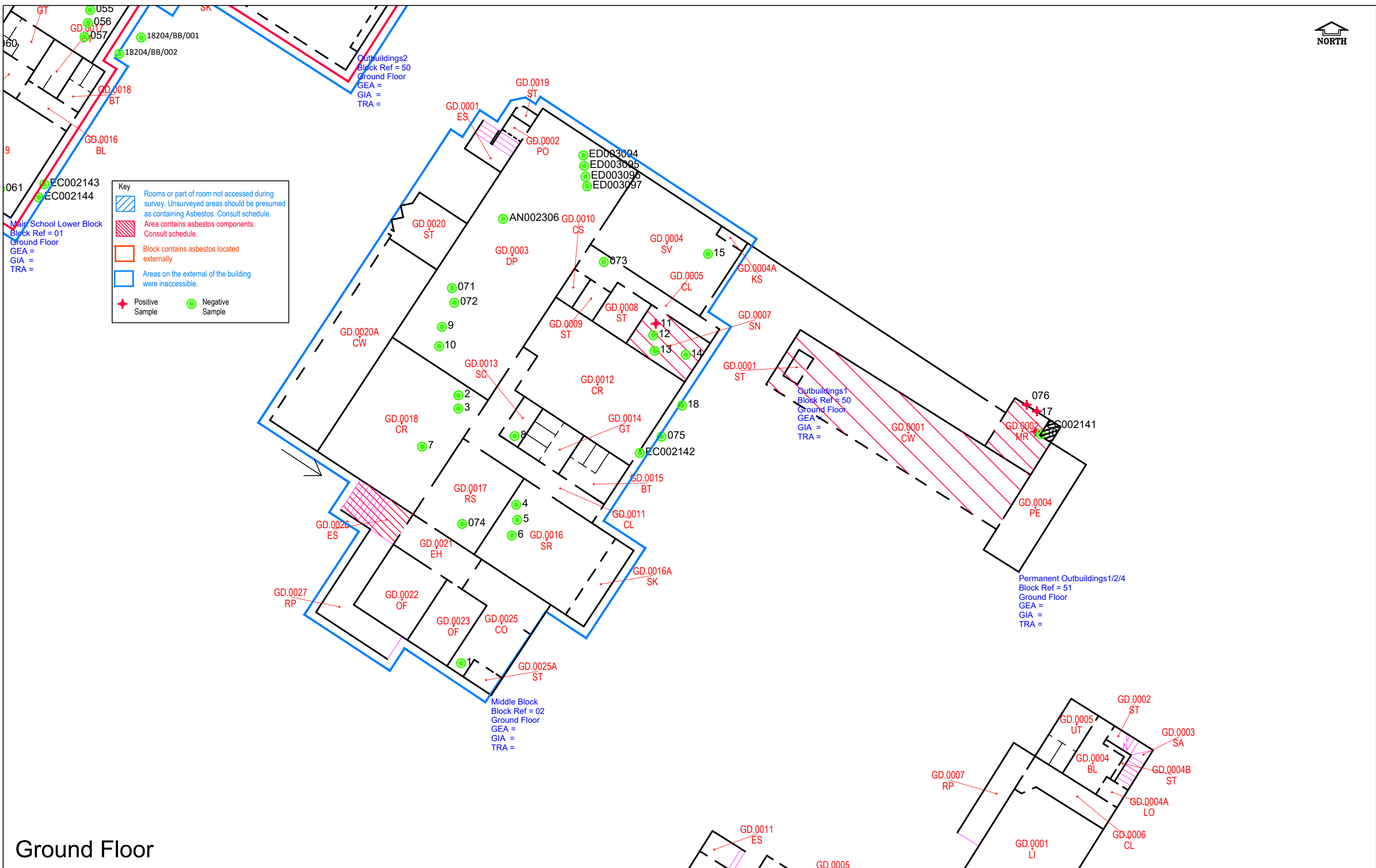

Ground Floor

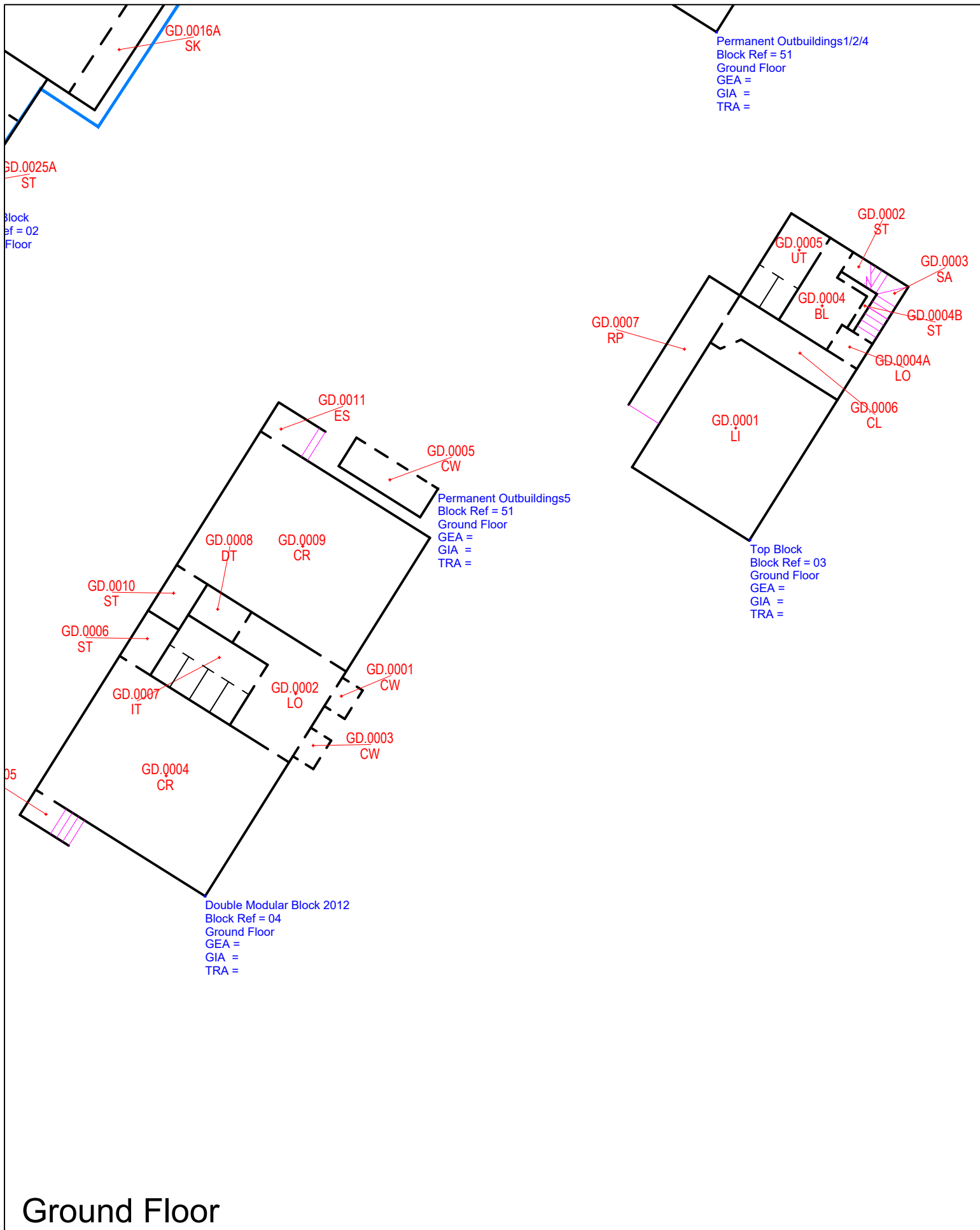

Key

- Rooms or part of room not accessed during survey. Unsurveyed areas should be presumed as containing Asbestos. Consult schedule.
- Area contains asbestos components. Consult schedule.
- Block contains asbestos located externally
- Areas on the external of the building were inaccessible.
- Positive Sample
- Negative Sample

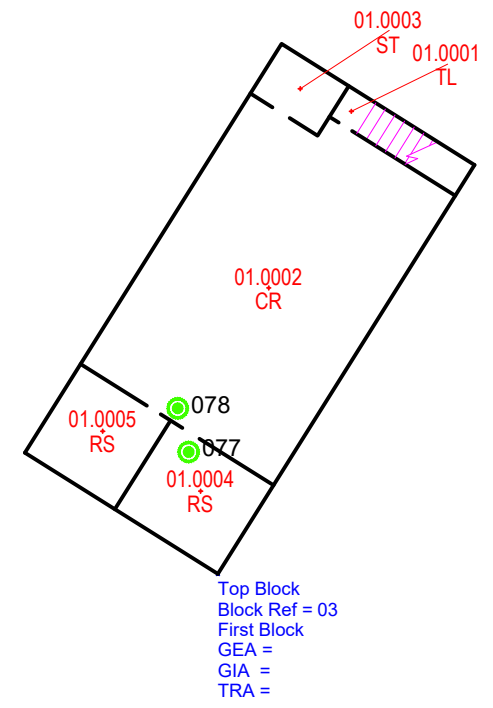

Ground Floor



Asbestos Bulk Analysis Report

Client	Technicon Environmental Services Ltd	Job Number	J13866
Client Job Ref	HRP1270	Batch Number	1277193444634
Client Address	Littlestone Moor Blackhorse Lane Clyst Honiton, Exeter Devon EX5 2AU	Samples From Address	Newtown Primary School Clifton Road Exeter Devon EX1 2ES
Report Version	23-06-2010 12:42:10 - v2	Date Received	22-06-2010
Page #	1 of 1	Date Analysed	22-06-2010
Analysis By	Janie Cleal		

Test #	Bag #	Material Type	Location	Asbestos Types
30508	HRP1106101	Board	Backing board to heater (Rm 2)	1) No Asbestos Detected in Sample ✓
30509	HRP1106102	Board	Base board to heater (Rm 2)	1) No Asbestos Detected in Sample ✓
30510	HRP1106103	Board	Backing board to heater (Rm 3)	1) No Asbestos Detected in Sample ✓
30511	HRP1106104	Board	Backing board to heater (Rm 1)	1) No Asbestos Detected in Sample ✓
30512	HRP1106105	Board	Backing board to heater (Rm 1)	1) No Asbestos Detected in Sample ✓
30513	HRP1506101	Board	Ceiling board Classroom 4	1) No Asbestos Detected in Sample ✓
30514	HRP1506102	Board	Ceiling board Classroom 1	1) No Asbestos Detected in Sample ✓
30515	HRP1506103	Vinyl Tile	Floor tile Classroom 1	1) Chrysotile ✓
End Of Report				

Authorised By: J. Cleal Name: JANIE CLEAL

Position: LABORATORY MANAGER

Fibre analysis has been carried out to the Noble Health and Safety Consultancy in-house method (appendix 7), which is based on HSG248 Appendix 2

No responsibility can be taken for information supplied by the client or for errors resulting from the clients sampling procedure. Material type has been reported using information submitted to the laboratory with the sample or by visual identification and fibre content in the laboratory. Changes to material type will only be made with the client's consent.

No Responsibility will be taken for subsequent interpretation and reproduction of these results by bodies other than Noble Health and Safety Consultancy.

11.0 BULK MATERIAL SAMPLE CERTIFICATE



CERTIFICATE FOR IDENTIFICATION OF ASBESTOS FIBRES

STANDARD	<input type="checkbox"/>
PREMIUM	<input type="checkbox"/>
EMERGENCY	<input type="checkbox"/>

Client:	ASBESTOS MANAGEMENT SPECIALIST 2000 LTD		
Address:	AMS HOUSE 1 BARBICAN CLOSE BARNSTAPLE EX32 9HE		
Attention:	C TUFFEY		
Site Address:	NEWTOWN PRIMARY SCHOOL LIFTON ROAD NEWTOWN EXETER DEVON		
Date sample taken:	04/09/12		
Date sample received:	05/09/12		
Date of Analysis:	05/09/12		
Analysis Report No.	SCO/12/26894		
Report Date:	05/09/12		
Site Ref No.	N/A		
Page No:	1	Of	1
No. of Samples:	4		
Obtained:	DELIVERED		

Samples of material, referenced below, have been examined to determine the presence of asbestos fibres, using Scopes Asbestos Analysis "in house" method of transmitted/polarised light microscopy and centre stop dispersion staining, based on HSE's HSG248.

If samples have been DELIVERED the site address and actual sample location is as given by the client at the time of delivery. Scopes Asbestos Analysis Services Limited are not responsible for the accuracy or competence of the sampling by third parties. Under these circumstances Scopes Asbestos Analysis Services Limited cannot be held responsible for the interpretation of the results shown.

SCOPES SAMPLE	CLIENT SAMPLE No.	Sample Location	Fibre Type Detected
1	EC002141	CORRUGATED ROOFING	CHRYSTOTILE
2	EC002142	BLOCK 2- ROOFING TILE	NADIS
3	EC002143	BLOCK 1- ROOFING TILE	NADIS
4	EC002144	BLOCK 1- ROOFING TILE	NADIS

KEY: NADIS - No Asbestos Detected in Sample

Note: All samples will be retained for a minimum of six months.

Note: This Certificate for Identification of Asbestos Fibres shall not be reproduced except in full without the written approval of the Laboratory.

Analysed by:	M. ZHOU	Authorised signatory:	
		Print name:	S BOLTON- Q.C.M

BULK 001-VER 5 12-AUGUST-09-QCM

2 Nobel Square, Courtauld Road, Burnt Mills Industrial Estate, Basildon, Essex SS13 1LS
Tel: 01268 724785 Fax: 01268 724796 Mob: 07765 685132 E-Mail: enquiries@scopesaasl.co.uk

Company Reg No: 5191390 Reg Address: As above

Unit C7
New Yatt Business Centre
New Yatt
Nr Witney
Oxfordshire, OX29 6TJ

Tel: 01993 868636
Fax: 01993 869080
www.asbestoslabs.co.uk



CERTIFICATE OF ANALYSIS FOR ASBESTOS FIBRES

Report Number: ALS/14/2467

Client	AMS 2000 Ltd	Attention	Matt Featherstone
Client Address	1 Barbican Close, Barnstaple, Devon, EX32 9HE		
Site Address	Newton Primary, Exeter		
Site Ref	Unknown	No. of Samples	04

Date Received	14/07/14	Date of Analysis	14/07/14	Report Issue Date	14/07/14
----------------------	----------	-------------------------	----------	--------------------------	----------

Samples of material(s) [detailed below] have been examined to determine the presence of asbestos fibres, using Polarised Light Microscopy together with dispersion staining based on the HSE's guidance document HSG248 and Asbestos Laboratory Services documented method. If samples have been delivered to the laboratory, the site address and sample location is reported as provided by the client. Asbestos Laboratory Services are not responsible for the accuracy or competence of the sampling by third parties. Under these circumstances Asbestos Laboratory Services cannot be held responsible for the interpretation of the results shown. Opinions and interpretations are outside the scope of the UKAS accreditation. The Determination of Asbestos Content Report shall not be reproduced except in full, without written approval of the laboratory.
An 'A' after the report number (or multiples of 'A') signifies that the original certificate (or subsequent amended certificate) has been replaced.

Lab Ref.	Client Sample Number	Sample Location	Sample Description	Fibre Type Detected
1	ED003094	GD0003DP	Ceiling Lining	N.A.D.I.S
2	ED003095	GD0003DP	Bitumen Under Parquet Flooring	N.A.D.I.S
3	ED003096	GD0003DP	Board at Heater	N.A.D.I.S
4	ED003097	GD0003DP	Putty to Windows	N.A.D.I.S

KEY

NADIS - No Asbestos Detected in Sample

Note: All samples will be retained for a minimum of six months.

Analysed By	Olivia Pearce
Analyst Signatory	 <small>Digitally signed by Olivia Pearce DN: cn=Olivia Pearce, o=Asbestos Labs, email=asbestoslabs@amiantus.co.uk, c=GB Date: 2014.07.14 15:10:01 +0100</small>

Approved By	Wai-Fung Kuet
Approver Signatory	 <small>Digitally signed by Wai-Fung Kuet DN: cn=Wai-Fung Kuet, o=Asbestos Labs, email=asbestoslabs@amiantus.co.uk, c=GB Date: 2014.07.14 15:24:24 +0100</small>

ALS14
Issued by: Quality Manager

Page 1 of 1

Issue Date: 28/10/13
Issue No. 4

Unit C7
New Yatt Business Centre
New Yatt
Nr Witney
Oxfordshire, OX29 6TJ

Tel: 01993 868636
Fax: 01993 869080
www.asbestoslabs.co.uk



4668

CERTIFICATE OF ANALYSIS FOR ASBESTOS FIBRES

Report Number: ALS/J000023

Client	AMS 2000 Ltd	Attention	Matt Featherstone
Client Address	1 Barbican Close, Barnstaple, Devon		
Site Address	Newtown Primary School, Exeter		
Site Ref	Unknown	No. of Samples	8

Date Received	18/08/2014	Date of Analysis	19/08/2014	Report Issue Date	19/08/2014
----------------------	------------	-------------------------	------------	--------------------------	------------

Samples of material(s) [detailed below] have been examined to determine the presence of asbestos fibres, using Polarised Light Microscopy together with dispersion staining based on the HSE's guidance document HSG248 and Asbestos Laboratory Services documented method. If samples have been delivered to the laboratory, the site address and sample location is reported as provided by the client. Asbestos Laboratory Services are not responsible for the accuracy or competence of the sampling by third parties. Under these circumstances Asbestos Laboratory Services cannot be held responsible for the interpretation of the results shown. Opinions and interpretations are outside the scope of the UKAS accreditation. The Determination of Asbestos Content Report shall not be reproduced except in full, without written approval of the laboratory'.
(V2), or subsequent 'V' numbers, after the report number signifies that the original certificate (or previous amended certificate) has been replaced.

Lab Ref.	Client Sample Number	Sample Location	Sample Description	Fibre Type Detected	Notes
BS000071	EH002911	Roof Space	Cement Roof Tiles & Debris	N.A.D.I.S	
BS000072	EH002912	Roof Space	Felt to Roof Areas	N.A.D.I.S	
BS000073	EH002913	Roof Space	Insulation	N.A.D.I.S	
BS000074	EH002914	Roof Space	Dust & Debris Sample 1	N.A.D.I.S	
BS000075	EH002915	Roof Space	Dust & Debris Sample 2	N.A.D.I.S	
BS000076	EH002916	Roof Space	Cement Roof Tiles & Debris	Chrysotile	
BS000077	EH002917	Roof Space	Textile Rope	N.A.D.I.S	
BS000078	EH002918	Main Hall	Insulating Panels Above Window	N.A.D.I.S	

Notes: N/A

NADIS - No Asbestos Detected in Sample

Note: All samples will be retained for a minimum of six months.

Analysed By	Peter Timms
Analyst Signatory	

Approved By	Olivia Pearce
Approver Signatory	

ALS14A

Issued by: Quality Manager

Page 1 of 1

Issue Date: 06/08/2014

Issue No. 1



CERTIFICATE FOR IDENTIFICATION OF ASBESTOS FIBRES

STANDARD	<input type="checkbox"/>
PREMIUM	<input type="checkbox"/>
EMERGENCY	<input type="checkbox"/>

Client:	ASBESTOS MANAGEMENT SPECIALIST 2000 LTD
Address:	AMS HOUSE 1 BARBICAN CLOSE BARNSTAPLE EX32 9HE
Attention:	C TUFFEY
Site Address:	NEWTON PRIMARY SCHOOL EXETER
Date sample taken:	22/08/13
Date sample received:	29/08/13
Date of Analysis:	29/08/13

Analysis Report No.	SCO/13/24325
Report Date:	29/08/13
Site Ref No.	N/A
Page No:	1 Of 1
No. of Samples:	5
Obtained:	DELIVERED

Samples of material, referenced below, have been examined to determine the presence of asbestos fibres, using Scopes Asbestos Analysis "in house" method of transmitted/polarised light microscopy and centre stop dispersion staining, based on HSE's HSG248.
If samples have been DELIVERED the site address and actual sample location is as given by the client at the time of delivery. Scopes Asbestos Analysis Services Limited are not responsible for the accuracy or competence of the sampling by third parties. Under these circumstances Scopes Asbestos Analysis Services Limited cannot be held responsible for the interpretation of the results shown.

SCOPES SAMPLE No.	CLIENT SAMPLE No.	Sample Location	Fibre Type Detected
1	EE000875	OFFICE – WALL LINING/CORE SAMPLE	NADIS
2	EE000876	INSULATION BOARD CEILING GRID THROUGHOUT	NADIS
3	EE000877	INSULATION TO PIPEWORK THROUGHOUT	NADIS
4	EE000878	CLASSROOM – PUTTY TO WINDOW	CHRYSTILE
5	EE000879	EXTERNAL – PUTTY TO WINDOW	CHRYSTILE

KEY: NADIS - No Asbestos Detected in Sample

Note: All samples will be retained for a minimum of six months.

Note: This Certificate for Identification of Asbestos Fibres shall not be reproduced except in full without the written approval of the Laboratory.

Analysed by:	W.JEFFERIES	Authorised signatory:	
		Print name:	S BOLTON- Q.C.M
BULK 001-VER 5 12-AUGUST-09-QCM			

2 Nobel Square, Courtauld Road, Burnt Mills Industrial Estate, Basildon, Essex SS13 1LS
Tel: 01268 724785 Fax: 01268 724796 Mob: 07765 685132 E-Mail: enquiries@scopesaasl.co.uk

Company Reg No: 5191390 Reg Address: As above

Appendix 2: Certificate of Bulk Sample Analysis



6093

Allium Environmental Ltd.
Baldhu House, Wheal Jane Earth
Science Park, Baldhu, Truro, TR3 6EH
Tel: 01872 276375
Email: enquiries@allium.uk.net Web: www.allium.uk.net



BULK ANALYSIS TEST REPORT



Report Number:	L-18204	Issue No:	1	Date Reported:	06/07/21	Page 1 of 1
Comments:						
Client:	NPS					
Client Address:	Venture House, 1 Capital Court, Sowton Ind Estate, Exeter, EX2 7FW					
Site Address/Location:	Newtown Primary School, Clifton Road, Newton, Exeter , Devon, EX1 2ES					
Date Sampled:	23/06/21	Sampled By:	Ben Beavis			
Date Samples Received:	28/06/21	Client Order No.:	NPSWI 21228786	No. of Samples:	2	
Date Analysed:	30/06/21	Analysed by:	Gary Lowe			

Analysis of samples was carried out in accordance with the documented 'in-house' procedures and methods based upon HSE Guidance Document HSG 248 Appendix 2. Comments, opinions and interpretations herein are outside the scope of UKAS accreditation. This report may not be reproduced except in full, without written approval of the laboratory.

ANALYSIS RESULTS

Lab Sample Ref. No.	Client Ref.	Sample Type	Sample Details/location/description	Asbestos Type (s)
001		Cement	Gable 3, External/Roof - Cement Roof Tiles	No Asbestos Detected
002		Cement	Gable 10, External/Roof - Cement Roof Tiles	No Asbestos Detected

- Materials have been referred to as Asbestos Insulating Board or Asbestos Cement based upon their asbestos content and visual appearance alone.
- Where samples have not been taken by Allium Environmental Ltd the results apply to the sample as received. It can only report analysis results. No responsibility can be taken for any consequences arising from the client's sampling strategy or procedures, for the acts or omissions of others, or the use of these results in subsequent reports.
- Samples marked \$ in this report have been subcontracted to a UKAS accredited laboratory.
- Quantification of the amount of asbestos is not permitted, if 1 or 2 fibres are observed and identified as asbestos, the term 'trace asbestos identified' will be reported.
- Sample(s) were examined for the presence of 6 types of asbestos fibres: Crocidolite (blue), Amosite (brown), Chrysotile (white), Anthophyllite, Actinolite and Tremolite.
- Where samples have been taken by Allium Environmental Ltd this has been to the in-house surveying/sampling procedure AL003, a copy of which is available on request.

Additional Comments:	Analyst:	Gary Lowe
	Analysts Signature:	
	Approved by:	Hadyn Veale
	Authorised Signature:	
E N D O F R E P O R T		

Section Two

Introduction

This report contains the findings of a Type 3 survey carried out by Mr Andrew Ellis of Noble Asbestos Consultancy Limited on the 5th April 2004 and is to provide information for refurbishments.

Our inspection was carried out in accordance with the requirements of MDHS 100. The definition of a Type 3 survey in MDHS 100 is:

"Type 3: Full access sampling and identification survey (pre-demolition/major refurbishment surveys).

This type of survey is used to locate and describe, as far as reasonably practicable, all ACM's in the building and may involve destructive inspection, as necessary, to gain access to all areas, including those that may be difficult to reach. A full sampling programme is undertaken to identify possible ACM's and estimates of the volume and surface area of ACM's made. The survey is designed to be used as a basis for tendering the removal of ACM's from the building prior to demolition or major refurbishment so the survey does not assess the condition of the asbestos, other than to note areas of damage or where additional asbestos debris may be expected to be present."

So far as is *reasonably practicable* all asbestos containing materials have been identified. The buildings were occupied at the time of our survey. This means that we could not be as invasive as if they were empty. *Reasonably practicable* is a defined legal term which infers a balance of cost versus risk and means that for example it is unlikely that we would find asbestos material used as formwork shuttering as this would need the concrete breaking open.

Clients must be aware that surveying is not a science and there may be undetected asbestos containing materials within the building.

It should be noted that the overriding duty to manage asbestos containing products under Regulation 4 of the Control of Asbestos at Work Regulations 2002 can not be delegated. This survey and subsequent recommendations form part of this compliance but the client should be aware that further action may be required.

Inspection was not carried out in the areas noted below, and limited to the areas accessible at the time of survey:

Areas Not Accessed: - Please refer to spreadsheet

Summary of Urgent Works: - None

Section Three

Building Description

Both the middle block and entrance block are of a solid construction with a pitched slate roof.

Section Five

Recommendations

Asbestos Cement

There are asbestos cement roof slates located on both the middle block and entrance block. At the time of the survey we also identified an asbestos cement sheet under a gas meter in room 01 of the entrance block.

Generally asbestos cement products are well bonded and the risk of fibre release is minimal provided they are not damaged. All relevant personnel should be made aware of their presence and they should be aware of the correct disposal procedures.

Any works due to be carried out may be done so by a Unlicensed Contractor using trained and competent personnel and following a safe system of work. A suggested safe system is laid down in publication HSG 210 – Asbestos Essentials. All arisings should be disposed of as special waste to an approved landfill site by a Registered Waste Carrier.



Non Accessed Areas

At the time of the survey we were unable to access heaters as the building was live so it was therefore unsafe. If these items are to be disturbed they should first be inspected by a competent person to discount the presence of any asbestos containing materials.

CERTIFICATE OF IDENTIFICATION OF ASBESTOS FIBRES

CLIENT	NPS South West (Exeter)	CERTIFICATE NO.	J013879
ADDRESS	Venture House, 1 Capital Court, Exeter, EX2 7FW	DATE OF ISSUE	06/07/2020
TELEPHONE	+44 (0) 1392 351064 M +44 (0) 7740 408010	DATE SAMPLED	26/06/2020
SITE ADDRESS	Newtown Primary School, Clifton Road, Newtown, Exeter, EX1 2ES	DATE RECEIVED	29/06/2020
SITE REFERENCE		DATE ANALYSED	01/07/2020
		NO. OF SAMPLES	1
		SAMPLED BY	Dave Chudleigh

CASA SAMPLE NUMBER	CLIENT SAMPLE NUMBER	SAMPLE LOCATION	FIBRE TYPE DETECTED
AN002306	N/A	Bitumen adhesive beneath parquet flooring	NADIS

COMMENTS			
KEY: NADIS - NO ASBESTOS DETECTED IN SAMPLE. CHRYSOTILE – WHITE ASBESTOS. AMOSITE – BROWN ASBESTOS. CROCIDOLITE – BLUE ASBESTOS TREMOLITE/ANTHOPHYLLITE & ACTINOLITE – LESS COMMON ASBESTOS FIBRE TYPE <small>Note: All comments are the opinion of the analyst only and do not form part of Casa's UKAS accreditation.</small> <small>Note: Samples will be kept for a minimum of 6 months.</small> <small>Note: This Certificate of Identification of Asbestos Fibres can only be reproduced with the written permission of Casa Environmental Services Limited.</small>			
ANALYSED BY	Jon House	AUTHORISED BY	Dawn Douglas
SIGNATURE		SIGNATURE	
<small>Authorisation by another member of staff is to confirm that the analysis was undertaken in accordance with in-house quality/technical procedures, current HSG248 guidance and by a suitably qualified analyst.</small>			
<small>Samples have been analysed to determine the presence of asbestos fibres using Casa Environmental Service Ltd "in house" method of polarised light microscopy and central stop dispersion staining based on HSG 248. Where the site address and sample locations have been provided by the client Casa Environmental Services Ltd is not responsible for the accuracy or competence of these details or of the sampling techniques that have been used and that results apply to the samples as they are received. Any sampling undertaken by Casa Environmental Services Ltd operatives has been undertaken using "in house" documented procedures which are based on guidance set out by the HSG 264.</small>			

Appendix 2: Certificate of Bulk Sample Analysis



6093

Allium Environmental Ltd.
Baldhu House, Wheal Jane Earth
Science Park, Baldhu, Truro, TR3 6EH
Tel: 01872 276375
Email: enquiries@allium.uk.net Web: www.allium.uk.net



BULK ANALYSIS TEST REPORT



Report Number:	L-08679	Issue No:	1	Date Reported:	24/01/19	Page 1 of 1
Comments:						
Client:	NPS					
Site Address/Location:	Newtown Primary School, Clifton Road, Newton, Exeter , Devon, EX1 2ES					
Date Sampled:	14/01/19	Sampled By:	Luke Jelfs			
Date Samples Received:	16/01/19	Client Order No.:	20948922	No. of Samples:	2	
Date Analysed:	16/01/19	Analysed by:	Gary Lowe			

Analysis of samples was carried out in accordance with the documented 'in-house' procedures and methods based upon HSE Guidance Document HSG 248 Appendix 2. Comments, opinions and interpretations herein are outside the scope of UKAS accreditation. This report may not be reproduced except in full, without written approval of the laboratory.

ANALYSIS RESULTS

Lab Sample Ref. No.	Client Ref.	Sample Type	Sample Details/location/description	Asbestos Type (s)
001		Cement	External, External/Roof - Cement Roof Tiles	No Asbestos Detected
002		Putty	External, External/Rainwater Goods - Putty	No Asbestos Detected

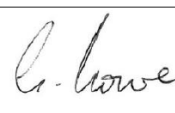
- Materials have been referred to as Asbestos Insulating Board or Asbestos Cement based upon their asbestos content and visual appearance alone.
- Where samples have not been taken by Allium Environmental Ltd, it can only report analysis results. No responsibility can be taken for any consequences arising from the client's sampling strategy or procedures, for the acts or omissions of others, or the use of these results in subsequent reports.
- Samples marked \$ in this report have been subcontracted to a UKAS accredited laboratory.
- Quantification of the amount of asbestos is not permitted, if 1 or 2 fibres are observed and identified as asbestos, the term 'trace asbestos identified' will be reported.
- Sample(s) were examined for the presence of 6 types of asbestos fibres: Crocidolite (blue), Amosite (brown), Chrysotile (white), Anthophyllite, Actinolite and Tremolite.
- Where samples have been taken by Allium Environmental Ltd this has been to the in-house surveying/sampling procedure AL003, a copy of which is available on request.

Additional Comments:	Analyst:	Gary Lowe
	Analysts Signature:	
	Approved by:	Viktoria Vrstiakova
	Authorised Signature:	
E N D O F R E P O R T		



Asbestos Bulk Analysis Report

Client	Technicon Environmental Services Ltd	Job Number	J15316
Client Job Ref	HRP1551	Batch Number	1305373068862
Client Address	Littlestone Moor Blackhorse Lane Clyst Honiton, Exeter Devon EX5 2AU	Samples From Address	Newtown Primary School Clifton Road Newtown Exeter EX1 2ES
Report Version	16-05-2011 12:37:39 - v1	Date Received	14-05-2011
Page #	1 of 1	Date Analysed	16-05-2011
Analysis By	Collin Wilkes		

Test #	Bag #	Material Type	Location	Asbestos Types
41227	HRP0905111	Asbestos Cement	Panel from classroom wall at high level.	1) Chrysotile
41228	HRP0905112	Asbestos Cement	Infill panel adjacent boxed in water tank.	1) Chrysotile
41229	HRP0905113	Asbestos Cement	Roof tile over store rooms.	1) Chrysotile
41230	HRP0905114	Asbestos Cement	Inner roof sheet over store.	1) Chrysotile
End Of Report				

Authorised By: Collin Wilkes Name: Collin Wilkes

Position: Asbestos Bulk Analyst

Fibre analysis has been carried out to the Noble Health and Safety Consultancy in-house method (NSOP7), which is based on HSG248 Appendix 2

No responsibility can be taken for information supplied by the client or for errors resulting from the clients sampling procedure. Material type has been reported using information submitted to the laboratory with the sample or by visual identification and fibre content in the laboratory. Changes to material type will only be made with the client's consent.

No Responsibility will be taken for subsequent interpretation and reproduction of these results by bodies other than Noble Health and Safety Consultancy. This test report shall not be reproduced except in full, without written approval of this laboratory.

APPENDIX 3

July 2018

Page 60 of 72

12 Appendix 3 – Bulk Sample Laboratory Certificates

Page 1 of 5



Analysis Report

Report Number: J024233

Issue Date: 02/08/2018

Private & Confidential:
HBI
HBI
PARKSIDE
BASINGSTOKE ROAD
SPENCERS WOOD
BERKS,
RG7 1AE

Premises of Sample Origin:
R18-04067

Analyst: Joe McIntyre

Sampled by: HBI

Date of Sample Receipt: 01/08/2018

Date of Analysis: 02/08/2018

Item No.	Lab Ref No.	SAMPLE LOCATION & DESCRIPTION	ASBESTOS FIBRE TYPE
1	BS018494	01 - BLOCK 2 GF RM GD.025 - INSULATING BOARD - HATCH PANEL - BULK ASBESTOS	NAD
2	BS018495	02 - BLOCK 2 GF RM GD.018 - BITUMEN DAMPER PAD - BULK ASBESTOS	NAD
3	BS018496	03 - BLOCK 2 GF RM GD.018 - FIBRE BOARD WALL PANELS - BULK ASBESTOS	NAD
4	BS018497	04 - BLOCK 2 GF RM GD.016 - BITUMEN SARKING FELT - BULK ASBESTOS	NAD

Notes:

Method Statement: Testing was performed in accordance with the Quality Control Manual in-house method of Eton Environmental Group Ltd, based on the published method HSG248. These results only apply to the sample analysed. Eton Environmental Group Ltd cannot accept responsibility for any discrepancy or inaccuracy arising from collection, labelling or description of samples by a third party.

NAD = No Asbestos Detected In Sample

Authorised Signatory:
Andrew Graham
Quality Manager

A handwritten signature in black ink, appearing to read "Andrew Graham", is written over a horizontal line.

This report may only be replicated in its entirety. Copies of this report are held by Eton Environmental Group Ltd.



Laboratory, Eton Environmental Group Ltd, Unit 1, Trinity Court, Faverdale, Darlington, DL3 0PH
Tel: 01325 366886 Fax: 01325 366914 Website www.etongroup.co.uk
Registered No. 5145774 Registered Office: 135 Slough Road, Datchet, SL3 9AE

Certificate of Analysis	Issue No: 7	Form 103	Issue Date: 20/02/17	Issue by: Quality Manager
-------------------------	-------------	----------	----------------------	---------------------------

APPENDIX 3

July 2018

Page 61 of 72

Page 2 of 5



Analysis Report

Report Number: J024233

Issue Date: 02/08/2018

Private & Confidential:

HBI
HBI
PARKSIDE
BASINGSTOKE ROAD
SPENCERS WOOD
BERKS,
RG7 1AE

Premises of Sample Origin:
R18-04067

Analyst: Joe McIntyre

Sampled by: HBI

Date of Sample Receipt: 01/08/2018

Date of Analysis: 02/08/2018

Item No.	Lab Ref No.	SAMPLE LOCATION & DESCRIPTION	ASBESTOS FIBRE TYPE
5	BS018498	05 - BLOCK 2 GF RM GD.016 - INSULATING BOARD PANEL BEHIND WATER - BULK ASBESTOS	NAD
6	BS018499	06 - BLOCK 2 GF RM GD.016 - INSULATING BOARD PANEL BELOW HEATER - BULK ASBESTOS	NAD
7	BS018500	07 - BLOCK 2 GF RM GD.018 - WINDOW PUTTY ABOVE PARTITION - BULK ASBESTOS	NAD
8	BS018501	08 - BLOCK 2 GF RM GD.013 - BLACK THERMOPLASTIC SKIRTING BOARD - BULK ASBESTOS	NAD

Notes:

Method Statement: Testing was performed in accordance with the Quality Control Manual in-house method of Eton Environmental Group Ltd, based on the published method HSG248. These results only apply to the sample analysed. Eton Environmental Group Ltd cannot accept responsibility for any discrepancy or inaccuracy arising from collection, labelling or description of samples by a third party.

NAD = No Asbestos Detected In Sample

Authorised Signatory:
Andrew Graham
Quality Manager

A handwritten signature in black ink, appearing to read "Andrew Graham", is written over a horizontal line.

This report may only be replicated in its entirety. Copies of this report are held by Eton Environmental Group Ltd.



Laboratory, Eton Environmental Group Ltd, Unit 1, Trinity Court, Faverdale, Darlington, DL3 0PH
Tel: 01325 366886 Fax: 01325 366914 Website www.etongroup.co.uk
Registered No. 5145774 Registered Office: 135 Slough Road, Datchet, SL3 9AE

Certificate of Analysis	Issue No: 7	Form 103	Issue Date: 20/02/17	Issue by: Quality Manager
-------------------------	-------------	----------	----------------------	---------------------------

APPENDIX 3

July 2018

Page 62 of 72

Page 3 of 5



Analysis Report

Report Number: J024233

Issue Date: 02/08/2018

Private & Confidential:

HBI
HBI
PARKSIDE
BASINGSTOKE ROAD
SPENCERS WOOD
BERKS,
RG7 1AE

Premises of Sample Origin:
R18-04067

Analyst: Joe McIntyre

Sampled by: HBI

Date of Sample Receipt: 01/08/2018

Date of Analysis: 02/08/2018

Item No.	Lab Ref No.	SAMPLE LOCATION & DESCRIPTION	ASBESTOS FIBRE TYPE
9	BS018502	09 - BLOCK 2 GF RM GD.003 - BITUMEN ADHESIVE BETWEEN PARQUET FLOOR - BULK ASBESTOS	NAD
10	BS018503	10 - BLOCK 2 GF RM GD.003 - INSULATING BOARD BEHIND HEATER - BULK ASBESTOS	NAD
11	BS018504	11 - BLOCK 2 GF RM GD.007 - TEXTURED COATING CEILING - BULK ASBESTOS	Chrysotile
12	BS018505	12 - BLOCK 2 GF RM GD.007 - INSULATION TO STORAGE HEATER - BULK ASBESTOS	NAD

Notes:

Method Statement: Testing was performed in accordance with the Quality Control Manual in-house method of Eton Environmental Group Ltd, based on the published method HSG248. These results only apply to the sample analysed. Eton Environmental Group Ltd cannot accept responsibility for any discrepancy or inaccuracy arising from collection, labelling or description of samples by a third party.

NAD = No Asbestos Detected In Sample

Authorised Signatory:
Andrew Graham
Quality Manager

A handwritten signature in black ink, appearing to read "Andrew Graham", is written over a horizontal line.

This report may only be replicated in its entirety. Copies of this report are held by Eton Environmental Group Ltd.



Laboratory, Eton Environmental Group Ltd, Unit 1, Trinity Court, Faverdale, Darlington, DL3 0PH
Tel: 01325 366886 Fax: 01325 366914 Website www.etongroup.co.uk
Registered No. 5145774 Registered Office: 135 Slough Road, Datchet, SL3 9AE

Certificate of Analysis	Issue No: 7	Form 103	Issue Date: 20/02/17	Issue by: Quality Manager
-------------------------	-------------	----------	----------------------	---------------------------

APPENDIX 3

July 2018

Page 63 of 72

Page 4 of 5



Analysis Report

Report Number: J024233

Issue Date: 02/08/2018

Private & Confidential:

HBI
HBI
PARKSIDE
BASINGSTOKE ROAD
SPENCERS WOOD
BERKS,
RG7 1AE

Premises of Sample Origin:
R18-04067

Analyst: Joe McIntyre

Sampled by: HBI

Date of Sample Receipt: 01/08/2018

Date of Analysis: 02/08/2018

Item No.	Lab Ref No.	SAMPLE LOCATION & DESCRIPTION	ASBESTOS FIBRE TYPE
13	BS018506	13 - BLOCK 2 GF RM GD.007 - INSULATION TO STORAGE HEATER - BULK ASBESTOS	NAD
14	BS018507	14 - BLOCK 2 GF RM GD.007 - INSULATING BOARD TO STORAGE HEATER - BULK ASBESTOS	NAD
15	BS018508	15 - BLOCK 2 GF RM GD.004 - LINO (BENEATH MODERN LINO) - BULK ASBESTOS	NAD
16	BS018509	16 - BLOCK 51 GF RM GD.02 - CEMENT PACKING - BULK ASBESTOS	NAD

Notes:

Method Statement: Testing was performed in accordance with the Quality Control Manual in-house method of Eton Environmental Group Ltd, based on the published method HSG248. These results only apply to the sample analysed. Eton Environmental Group Ltd cannot accept responsibility for any discrepancy or inaccuracy arising from collection, labelling or description of samples by a third party.

NAD = No Asbestos Detected In Sample

Authorised Signatory:
Andrew Graham
Quality Manager

A handwritten signature in black ink, appearing to read "Andrew Graham", is written over a horizontal line.

This report may only be replicated in its entirety. Copies of this report are held by Eton Environmental Group Ltd.



Laboratory, Eton Environmental Group Ltd, Unit 1, Trinity Court, Faverdale, Darlington, DL3 0PH
Tel: 01325 366886 Fax: 01325 366914 Website www.etongroup.co.uk
Registered No. 5145774 Registered Office: 135 Slough Road, Datchet, SL3 9AE

Certificate of Analysis	Issue No: 7	Form 103	Issue Date: 20/02/17	Issue by: Quality Manager
-------------------------	-------------	----------	----------------------	---------------------------

APPENDIX 3

July 2018

Page 64 of 72

Page 5 of 5



Analysis Report

Report Number: J024233

Issue Date: 02/08/2018

Private & Confidential:

HBI
HBI
PARKSIDE
BASINGSTOKE ROAD
SPENCERS WOOD
BERKS,
RG7 1AE

Premises of Sample Origin:
R18-04067

Analyst: Joe McIntyre

Sampled by: HBI

Date of Sample Receipt: 01/08/2018

Date of Analysis: 02/08/2018

Item No.	Lab Ref No.	SAMPLE LOCATION & DESCRIPTION	ASBESTOS FIBRE TYPE
17	BS018510	17 - AREA EX 51 - CEMENT ROOF TILES - BULK ASBESTOS	Chrysotile
18	BS018511	18 - AREA EX 2 - BITUMEN DAMP PROOF COURSE - BULK ASBESTOS	NAD

Notes:

Method Statement: Testing was performed in accordance with the Quality Control Manual in-house method of Eton Environmental Group Ltd, based on the published method HSG248. These results only apply to the sample analysed. Eton Environmental Group Ltd cannot accept responsibility for any discrepancy or inaccuracy arising from collection, labelling or description of samples by a third party.

NAD = No Asbestos Detected In Sample

Authorised Signatory:
Andrew Graham
Quality Manager

A handwritten signature in black ink, appearing to read "Andrew Graham", is written over a light blue horizontal line.

This report may only be replicated in its entirety. Copies of this report are held by Eton Environmental Group Ltd.



Laboratory, Eton Environmental Group Ltd, Unit 1, Trinity Court, Faverdale, Darlington, DL3 0PH
Tel: 01325 366886 Fax: 01325 366914 Website www.etongroup.co.uk
Registered No. 5145774 Registered Office: 135 Slough Road, Datchet, SL3 9AE

Certificate of Analysis	Issue No: 7	Form 103	Issue Date: 20/02/17	Issue by: Quality Manager
-------------------------	-------------	----------	----------------------	---------------------------